

867

## Additional Instructions

Locking set for adjusting elements

**IMPORTANT**  
**READ CAREFULLY BEFORE USE**  
**KEEP FOR FUTURE REFERENCE**

All rights reserved.

Property of Dürkopp Adler AG and protected by copyright. Any reuse of these contents, including extracts, is prohibited without the prior written approval of Dürkopp Adler AG.

Copyright © Dürkopp Adler AG 2017

---

<b>1</b>	<b>Components of the kit.....</b>	<b>3</b>
<b>2</b>	<b>Fitting the kit .....</b>	<b>4</b>
2.1	Blocking of the needle thread tension .....	4
2.2	Blocking of the sewing foot pressure adjusting wheel .....	4
2.3	Blocking of the sewing foot stroke adjustment wheel .....	5
2.4	Blocking of the stitch length adjusting wheel .....	6



## 1 Components of the kit

Check whether the scope of delivery for kit 0667 595204 is correct prior to installing it.

Part number	Quantity	Description
0667 115680	1	Holder
0667 115690	1	Bushing
0667 135310	1	Bushing
0667 135320	1	Plate
0667 165620	1	Clamp
0667 315464	1	Socket/Adjusting wheel
9202 002107	1	Screw M4x20
9202 002117	1	Screw M4x25
9204 202067	1	Screw M5x35-H

## 2 Fitting the kit

### 2.1 Blocking of the needle thread tension

Fig. 1: Blocking of the needle thread tension

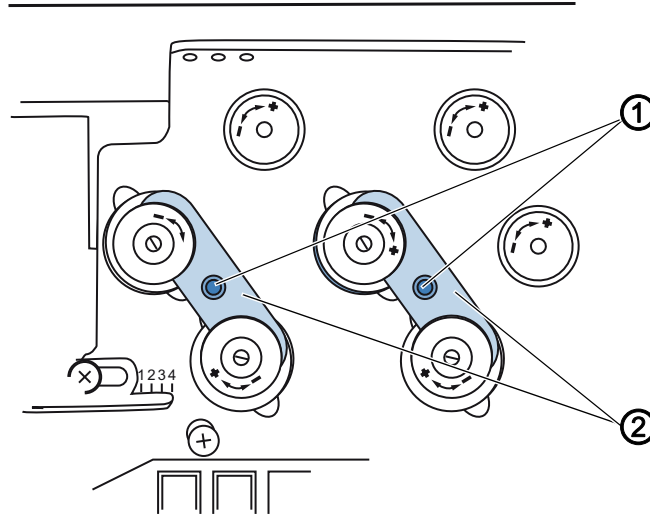

(1) - Fastening screw

(2) - Retaining plate



1. Adjusting the needle thread tension ( *Operating Instructions 867, Adjusting the needle thread tension*).
2. Fit the retaining plate (2).
3. Tighten the fastening screws (1).

### 2.2 Blocking of the sewing foot pressure adjusting wheel

Abb. 2: Blocking of the sewing foot pressure adjustment wheel

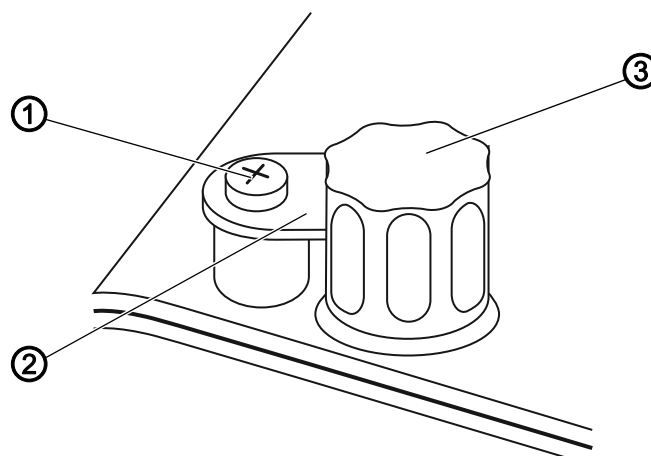

(1) - Fastening screw

(2) - Retaining plate

(3) - Adjusting wheel for the sewing foot pressure



1. Turn the adjusting wheel for the sewing foot pressure (3) ( *Operating Instructions 867, Setting the sewing foot pressure*).

2. Fit the retaining plate (2).
3. Tighten the fastening screw (1).

### 2.3 Blocking of the sewing foot stroke adjustment wheel

Abb. 3: Blocking of the sewing foot stroke adjustment wheels (1)

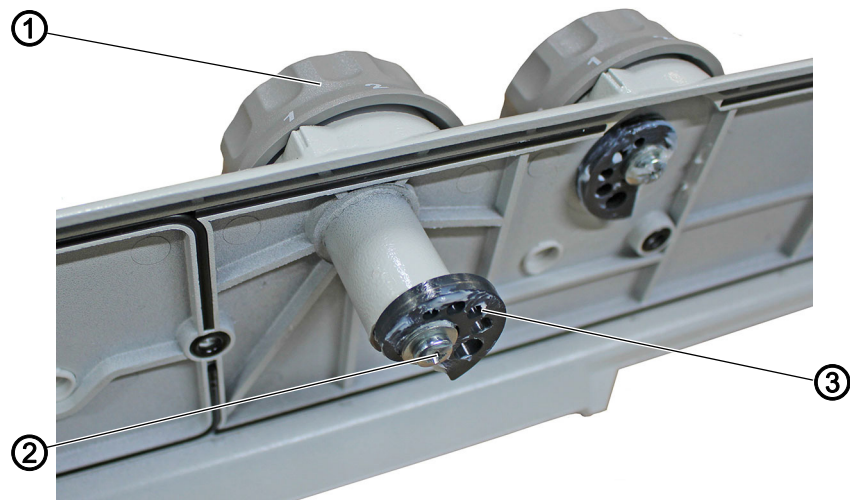

- (1) - Adjusting wheel  
(2) - Screw

(3) - Worm





1. Loosen arm cover ( Service Instructions 867).
2. Loosen screw (2) at the bottom of the arm cover.
3. Replace adjusting wheel (1).
4. Assemble worm (3) like shown in the picture (adjusting wheel at position 1).
5. Tighten the adjusting wheel with screw (2).
6. Assemble arm cover ( Service Instructions 867).

Abb. 4: Blocking of the sewing foot stroke adjustment wheels (2)



(4) - Fastening screws

(5) - Adjusting wheels for the sewing foot stroke

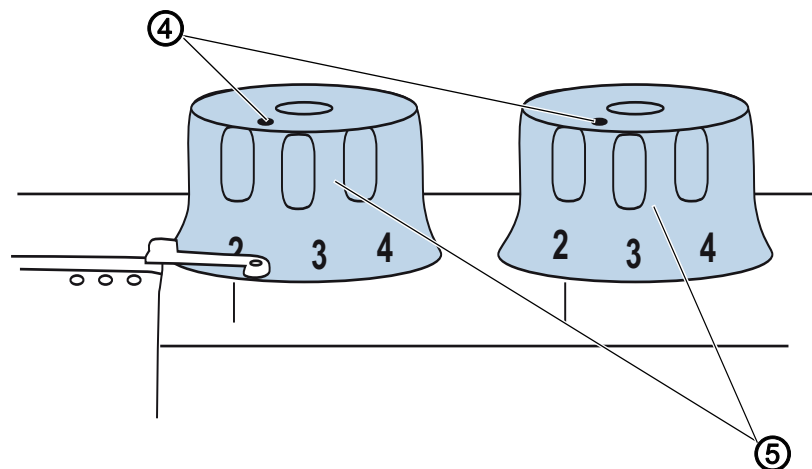
7. Turn the adjusting wheel for the sewing foot stroke (2)  
(📖 *Operating Instructions 867, Setting the sewing foot stroke*).
8. Tighten the fastening screws (1).

## 2.4 Blocking of the stitch length adjusting wheel

### WARNING



#### Risk of injury from moving parts!

Switch off the sewing machine before removing blocking of the stitch length adjusting wheels.

Abb. 5: Blocking of the stitch length adjusting wheel (1)

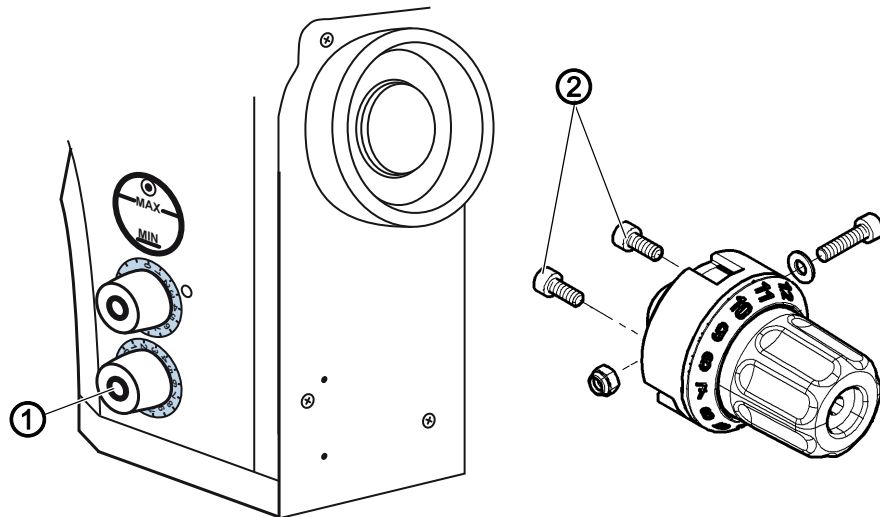

(1) - Adjusting wheels for the stitch length (2) - Screw



1. Loosen Screws (2) from the inner side, then remove adjusting wheel (1).

Fig. 6: Blocking of the stitch length adjusting wheel (2)

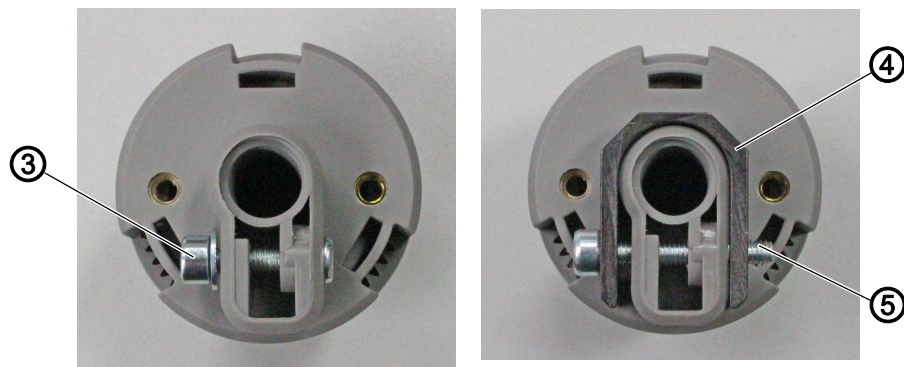

(3) - Screw  
(4) - Clamp

(5) - Screw



2. Loosen screw (3).
3. Fix Clamp (4) with screw (5) to the adjusting wheel (1).
4. Assemble adjusting wheel (1) to the machine.

Abb. 7: Blocking of the stitch length adjusting wheel (3)

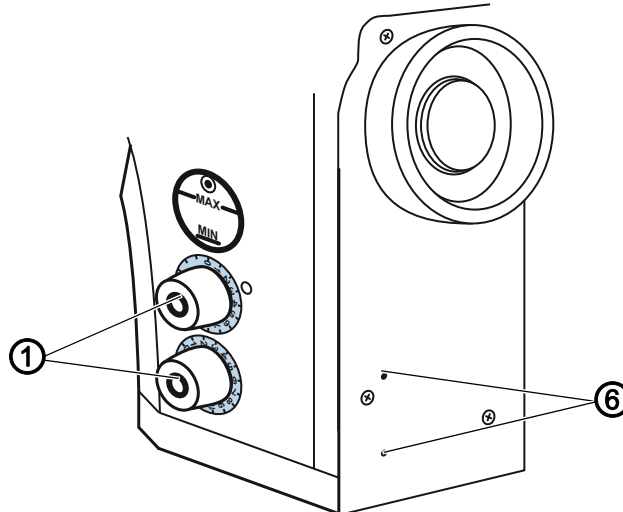

(1) - Adjusting wheels for the stitch length (6) - Access holes

5. Turn the stitch length adjusting wheels (1)  
( *Operating Instructions 867, Stitch length*).
6. Insert a 3 mm hex key through the access holes (6) and tighten the blocking screws for the stitch length adjusting wheels.







DÜRKOPP ADLER AG  
Potsdamer Str. 190  
33719 Bielefeld  
Germany  
Phone: +49 (0) 521 925 00  
E-Mail: [service@duerkopp-adler.com](mailto:service@duerkopp-adler.com)  
[www.duerkopp-adler.com](http://www.duerkopp-adler.com)