



Instructions for service

4220i - 6

CONTENTS:

1. General safety instructions	1
2. Introduction	1
3. Head of the sewing machine	2
3.1 Hook and hook post	2
3.1.1 Description	
3.1.2 Height setting of the hook	
3.1.3 Setting the distance of the hook from the needle	
3.1.4 Angular setting of the hook (timing)	
3.1.5 Protection of the needle and of the hook point	
3.1.6 Setting of the bobbin case opener	
3.1.7 Setting the regulation of the hook lubrication	
3.1.8 Replacement of the hook	
3.1.9 Setting the gear	
3.1.10 Dismantling of the hook post	
3.2 Needle and thread mechanism	5
3.2.1 Description	
3.2.2 To check the handwheel angular adjustment	
3.2.3 Height setting of the needle bar	
3.2.4 Angular setting of the pin of the thread mechanism	
3.2.5 Side setting of the needle bar holder	
3.2.6 Setting the needle (the needle bar holder)	
3.3 Throat plate and its post	7
3.3.1 Description	
3.3.2 Mounting and removing the throat plate and its insert	
3.3.3 Side setting of the throat plate post	
3.4 Thread tensioners and limiter	8
3.4.1 Description	
3.4.2 Setting the tension of main and auxiliary tensioners	
3.4.3 Setting the tensioning mechanisms of the main tensioners	
3.4.4 Setting the adapting spring	
3.4.5 Setting the thread limiter	
3.5 Feeding mechanism of the bottom feed	10
3.5.1 Description	
3.5.2 <u>Stitch length mechanism</u>	
3.5.2.1 Setting of the horizontal component of the feeder movement (setting of the upper feeding eccentric)	
3.5.2.2 Setting of the vertical component of the feeder movement	
3.5.2.3 Setting of the feeder position against the throat plate	
3.5.2.4 Setting of the height of the feeder teeth, setting of the feeding balance beam	
3.5.2.5 Forward and rearward stitch length distribution (rough)	
3.5.2.6 Forward and rearward stitch length distribution (fine)	
3.5.2.7 Setting of the control knob (including the stitch length limitation)	
3.5.2.8 Feeder replacement	
3.6 Feeding mechanism of the top roller	14
3.6.1 Description	
3.6.2 Feeding clutch	
3.6.2.1 Description	
3.6.2.2 Setting of the feeding pitch	
3.6.2.3 Setting of the lower eccentric	
3.6.2.4 Setting the engagement and disengagement of the clutch	
3.6.3 Side setting of the indented lower pulley	
3.6.4 Side setting of the indented upper pulley	
3.6.5 Setting the tensioning roller	
3.6.6 Replacement of the indented belt	

3.6.7	Top roller	
3.6.7.1	Selection of the top roller diameter	
3.6.7.2	Forward, rearward and side setting	
3.6.7.3	Setting the gear clearance and in the mounting of the top roller	
3.6.7.4	Setting of the height and of the pressing force of the top roller	
3.6.7.5	Replacement of the top roller	
3.7	Setting the presser foot lift	19
3.8	Bobbin winder	20
3.8.1	Description	
3.8.2	Setting the bobbin winder stop	
3.8.3	Setting the friction gear	
3.9	Safety clutch	21
3.9.1	Description	
3.9.2	Setting the disengaging moment	
3.10	Indented belt transmission	21
3.10.1	Setting the tensioning roller of the indented belt	
3.10.2	Replacing the indented belt	
3.11	V-belt, motor - head	22
3.11.1	Tensioning	
3.11.2	Replacing the V-Belt	
3.12	Driving toothed belt	22
3.12.1	To exchange the driving toothed belt	
3.13	Lubrication	23
3.13.1	Description	
3.13.2	Refilling oil	
3.13.3	Multiple oil use	
4.	Thread trimming	24
4.1	Description of the trimming mechanism	
4.2	Setting the pickup roller	
4.3	Setting the cam	
4.4	Setting the fork	
4.5	Setting the moving knife	
4.6	Setting the fixed knife	
4.7	Setting the retaining spring of the hook thread	
4.8	Setting switching of the electromagnets	
5.	Lifting the top roller by electromagnet	26
5.1	Description	
5.2	Setting the electromagnet pin	
5.3	Setting the electromagnet current	
5.4	Assembly of the top roller lifting electromagnet	
6.	Backtacking using electromagnet	27
6.1	Description	
6.2	Electromagnet height setting	
6.3	Setting the position of push-buttons	
6.4	Change of the function of push-buttons	
7.	Connecting the electric elements on the machine head	28
8.	Drive, control panel, position sensor	28
9.	Maintenance (table of operations)	29
10.	Setting the machine according to the sewing category	29
10.1	Introduction	
10.2	Table of setting the machine according to the sewing category	

1. General safety instructions

The non-observance of the following safety instructions can cause bodily injuries or damages to the machine.

1. The machine must only be commissioned in full knowledge of the instruction book and operated by persons with appropriate training.
2. Before putting into service also read the safety rules and instructions of the motor supplier.
3. The machine must be used only for the purpose intended. Use of the machine without the safety devices is not permitted. Observe all the relevant safety regulations.
4. When gauge parts are exchanged (e.g. needle, top roller, needle plate, feed dog and bobbin) when treading, when the workplace is left, and during service work, the machine must be disconnected from the mains by switching off the master switch or disconnecting the mains plug.
5. Daily servicing work must be carried out only by appropriately trained persons.
6. Repairs, conversion and special maintenance work must only be carried out by technicians or persons with appropriate training.
7. For service or repair work on pneumatic systems the machine must be disconnected from the compressed air supply system. Exceptions to this are only adjustments and function checks made by appropriately trained technicians.
8. Work on the electrical equipment must be carried out only by electricians or appropriately trained persons.
9. Work on parts and systems under electric current is not permitted, except as specified in regulations DIN VDE 0105.
10. Conversions or changes to the machine must be authorized by us and made only in adherence to all safety regulations.
11. For repairs, only replacement parts approved by us must be used.
12. Commissioning of the sewing head is prohibited until such time as the entire sewing unit is found to comply with EC directives.



It is absolutely necessary to respect the safety instructions marked by these signs.
Danger of bodily injuries !
Please note also the general safety instructions.

IMPORTANT WARNING

In spite of all safety measures made on the machines, inappropriate actions of the operator may lead to dangerous situations. In industrial sewing machines, attention should be paid to the following still remaining possible sources of injury:

1. Moving sewing needle
 - risk of injury when sewing with raised pressure foot or top roller, because the finger guard is then positioned too high,
 - risk of injury when inadvertently threading down of the motor treadle.
2. Moving thread take-up lever
 - risk of injury when inadvertently or intentionally inserting the finger(s) between the thread take-up lever and its guard.
3. Moving pressure member
 - risk of injury when holding sewn work in immediate vicinity of the pressure member and beginning to insert under the pressure member a considerably thicker sewn work portion,
 - risk of injury when sinking the pressure member.
4. When switched off, the clutch motor slows down by inertia but would be reactivated by an accidental treading down of the motor treadle. To avoid such risk, it is advised to hold the handwheel by hand and slightly to depress the motor treadle.

2. Introduction

This service book contains instruction for regulating the mechanisms of the sewing machine head.

The instructions for use and for putting the machine into operation and for the control of the stopmotor are not included in this service book, but they are supplied as separate publications.

This service book is universal for all subclasses of the machine - it contains setting procedures for all elements which may be placed on the machine of the given class. When the supplied subclass of this machine does not include some element, then it is possible to leave out the respective parts of the instructions. The optional equipments of the machine and the respective configurations of the subclasses of the machine are given in the operating instructions.

This sewing machine disposes of a large extent of its use. The machine should be set with respect to the parameters of the sewn material, the sewing thread etc. The setting for the individual categories is given in the chapter 11.2.

For setting the machine, simple setting aids are used which are included in the accessory of the machine. Besides these aids, universal measuring devices are used, such as slide calliper, feeler gauges and dynamometer for measuring the thread tension.

3. Head of the sewing machine

3.1 Hook and the hook post

3.1.1 Description

The hook (1) is mounted on the shaft (2) and is driven by the gear (3) from the shaft (4).

The shaft of the hook (2) is slidably mounted on the top, in post and, on the bottom, in a needle bearing.

The hook is provided with a lever (5) which is tilted when removing the bobbin (6). The protecting sheet (7) protects against the collision of the needle with the hook point. The bobbin case opener (8) is driven by the eccentric (9) on the shaft (2).

The oil tank (10) contains oil supply for the hook lubrication. Superfluous oil is taken by the felt piece (11) used to lubricate sliding mounting hook shafts. The wick connected to the felt piece (11) lubricates the gearing (3).

The screws (12) serve for taking up the clearance of the gear. The screws (13) fasten the post to the bedplate.

3.1.2 Height setting of the hook

The designated distance „A“ should be 5.3 mm.



Caution! Danger of injury!

Switch off the main switch ! Before starting the setting operation, wait until the motor stops!

- Loosen both screws (1).
- By axial shifting of the bushing (2) set the axial clearance of the wheel (3) to the least value still ensuring easy rotation of the shaft (4) with the fixed wheel (3).
- Tighten both screws (1).
- Loosen both screws (5).
- Shift axially the shaft (4) with the hook (6) so as to obtain the required distance „A“. For setting up use the setting gauge (7) as per the respective figure.
- Carefully retighten the screws (5) after the adjustment. Caution! One of these screws must bear on the flat of the shaft (4).

3.1.3 Setting the distance of the hook from the needle

The hook point (1) is set up to the maximum distance of 0.1 mm from the bottom of the needle recess (2). For the sewing categories 1 and 2, the needle size 100 is set, for the sewing categories 3 and 4, it is the needle size 160.



Caution! Danger of injury!

Switch off the main switch ! Before starting the setting operation, wait until the motor stops!

- Loosen only one screw (4).
- Loosen the screws (5) and tighten them only slightly.
- Shift the hook post (6) at the determined distance between the needle and the hook point.
- Tighten carefully the screw (4) (be sure not to damage the threads!)
- Tighten duly the screws (5).
- Check up the setting using a narrow strip of thin paper and proceed to the eventual correction of setting.



Caution!

When changing substantially the sewing category, the protecting sheet of the hook (7) should be set up.

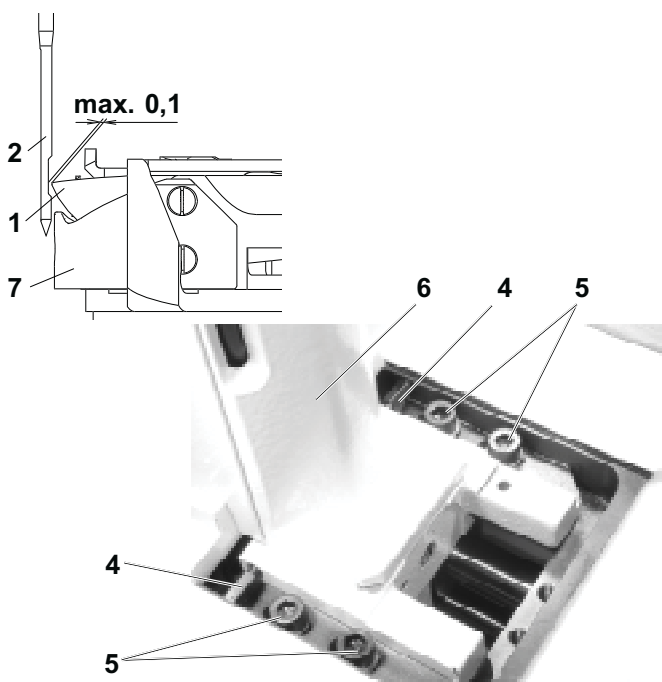
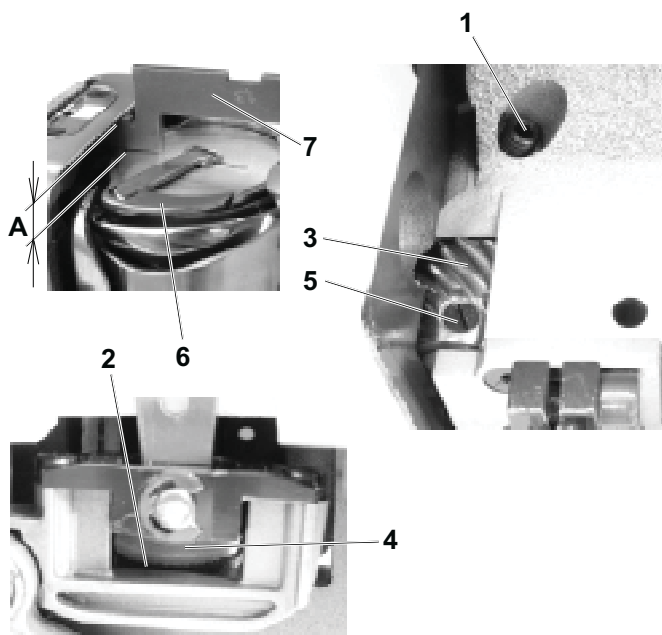
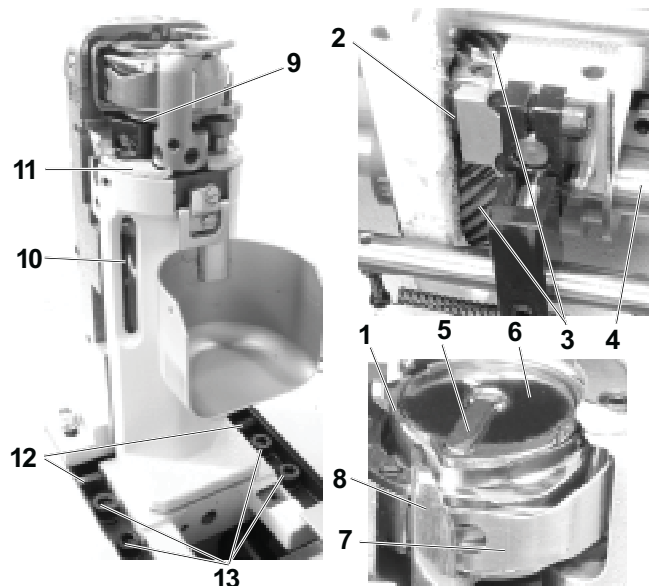

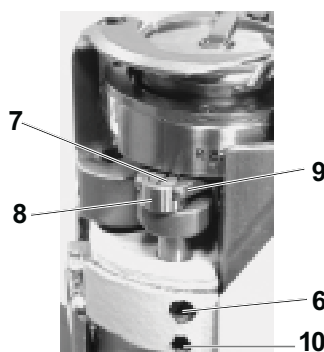
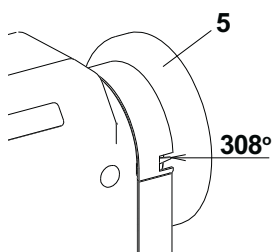
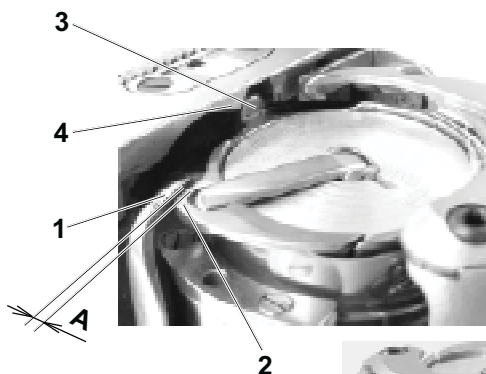
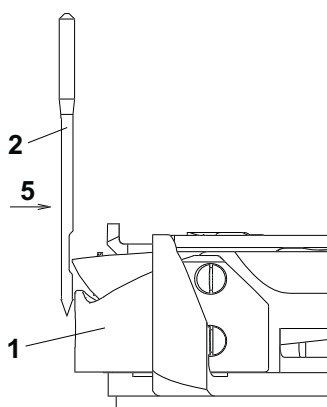
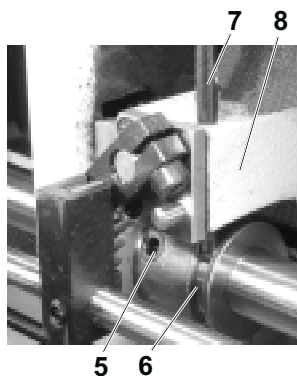
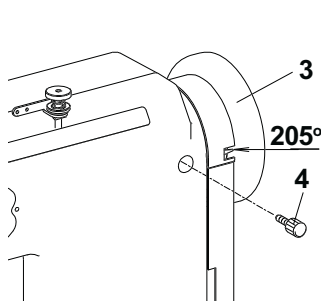
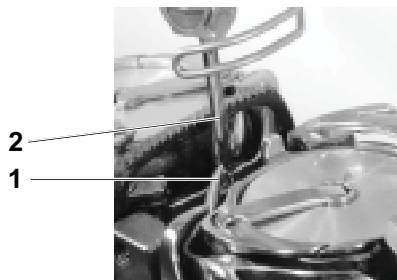

3.1.4 Angular setting of the hook (timing)

The hook is to be angularly set in such a way that the hook point (1) is opposite the needle at the moment, when the needle shifts by 2.5 mm from its bottom dead center. This corresponds to the 205° on the scale of the handwheel (3).



Caution! Danger of injury!

Switch off the main switch! Before starting the setting operation, wait until the motor stops!

- Remove the throat plate.
- Turn the handwheel (3) to the 205° and fix it with the screw (4) which is component part of the accessory of the machine (tighten it carefully).
- Loosen the screws (5).
- Turn the hook into the required position.
- Pass the locating pin (7) contained in the machine accessories through the hole in the hook post bed (8) and insert it into the groove of the gear wheel (6). In this way, the wheel is axially set.
- Tighten to the maximum the screws (5) and take the locating pin (7) out.

3.1.5 Protection of the needle and of the hook point

The protecting sheet (1) is to be set up in such a way that the clearance between the protecting sheet and the needle (2) is the least possible.



Caution ! Danger of injury!

Switch off the main switch! Before starting the setting operation, wait until the motor stops!

- Remove the throat plate and the movable trimming knife.
- Unscrew the screw (3).
- Put the screwdriver into the hole of the screw (3) and, using the regulating screw, set up the required clearance between the needle (2) and the protecting sheet (1). When turning to the right, the protecting sheet shifts out from the groove and inversely.
- Check up the protecting effect in pushing against the needle in the sense of the arrow (5). The hook point must not catch the needle. If so, set up the protecting effect, correct eventually the setting of the distance of the hook point from the needle according to the paragraph 3.1.3.
- Screw in the screw (3).

3.1.6 Setting of the bobbin case opener

The bobbin case opener (1) is to be set in such a way that, at the moment when the opener is in its dead centre, there would be a clearance „A“ between the opener (1) and the projection (2), whereas the finger (3) bears on the projection (4), „A“ = 0.7 mm for the sewing category 1 and 2, „A“ = 0.3 mm for the sewing category 3 and 4.



Caution ! Danger of injury!

Switch off the main switch! Before starting the setting operation, wait until the motor stops!

- On the handwheel (5), set the angle of 308° (the hook is in its dead centre).
- Loosen the screw (6).
- Turn the eccentric (7) in such a way that the required clearance between the elements (1) and (2) is attained.
- By turning the screw (10), set the height of the eccentric (7) in such a way that it is in its highest position in retaining the minimum clearance between the slide (8) and the fork (9).
- Tighten duly the screw (6).

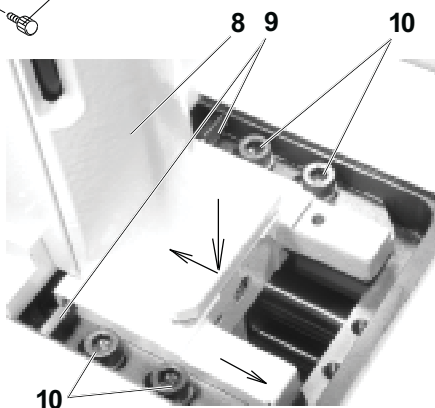
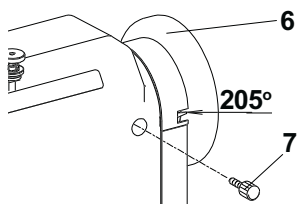
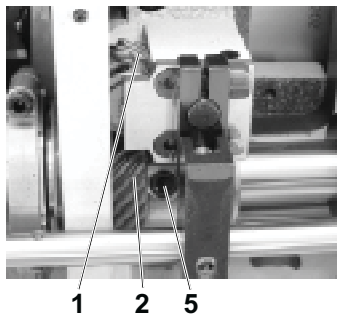
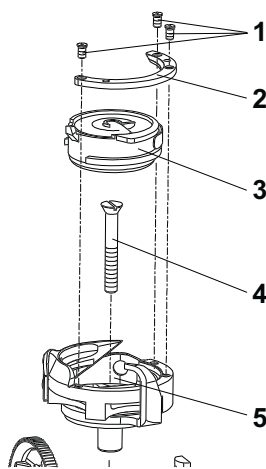
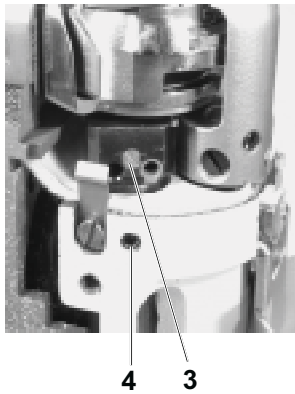

3.1.7 Setting the regulation of the hook lubrication

Oil is wiped from the lubrication wick by the surface of the hook eccentric and is then supplied by centrifugal force into the hook path (7). The intensity of oil supply is regulated by turning the screw (3).



Caution! Danger of injury!

Switch off the main switch ! Before starting the setting operation, wait until the motor stops!

- To reduce the oil supply, turn the screw (3) to the right.
- To increase the oil supply, turn the screw (3) to the left.
- After the adjustment, loosen the screw (4) and set the height of the oil tank so as to ensure reliable contact between the surface of the eccentric and the lubrication wick.



Caution!

The quantity of the fed oil has been set up in the manufacturing factory. This setting is to be done only in emergency events. A bad setting of the quantity of the fed oil or of the height of the lubricating tube may cause a rapid wear or a seizure of the hook.

3.1.8 Replacement of the hook



Caution! Danger of injury!

Switch off the main switch ! Before starting the setting operation, wait until the motor stops!

- Remove the throat plate and the trimming knife together with its holder.
- Unscrew the screws (1) and remove the splice (2).
- After having suitably turned a bit the hook, remove the bobbin case (3).
- Unscrew thoroughly the screw (4).
- Remove the body of the hook (5) upwards.
- When mounting, the procedure is inverse.

3.1.9 Setting the gear

The mutual angular orientation of the gear wheel (1) relative to the gear wheel (2) should ensure the accessibility of the screw (5) at the moment when the hook point comes to lie opposite the needle (4). The wheel (2) is to be set with its gear rim symmetrically to the centre of the gear wheel (1). The clearance between the gear wheels is to be the least possible.



Caution ! Danger of injury!

Switch off the main switch! Before starting the setting operation, wait until the motor stops!

- Set the angle of 205° on the handwheel (6) and lock it with the screw (7).
- On the removed post of the hook (8), according to the paragraph 3.1.10, the hook point (3) is to be turned a bit according to the illustration.
- Turn the gear wheel (2) into the suitable position and insert the post of the hook into the machine according to the respective arrows. Check up, whether the screw (5) is accessible and, if not, repeat the procedure.
- Set the the distance of the hook from the needle according to the paragraph 3.1.3.
- Set the precise angular displacement of the hook according to the paragraph 3.1.4.
- Loosen the screw (10) and tighten them slightly.
- Set the clearance in the gear in turning the screws (9). Check up, whether the gear has a clearance during the whole revolution of the hook. Turn the handwheel step by step by 15° and, with each step, grasp the hook and try, if there is an angular dead travel. Tighten carefully the screws (9).
- Tighten duly the screws (10) and try anew the clearance of the gear.

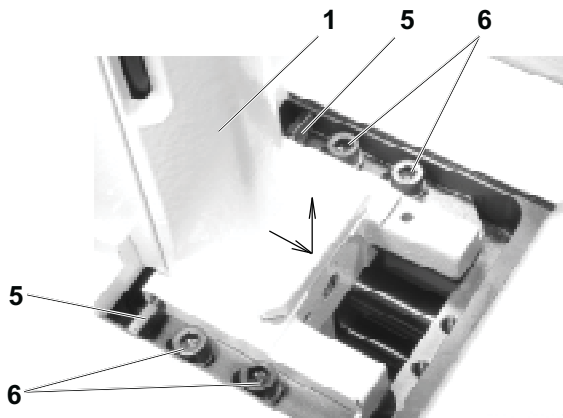

3.1.10 Dismantling of the hook post



Caution ! Danger of injury!

Switch off the main switch! Before starting the setting operation, wait until the motor stops!

- Loosen only one screw (5).
- Unscrew the screws (6).
- Shift the post(1) in the sense of the arrows and remove it out from the machine.
- When mounting it, proceed inversely.

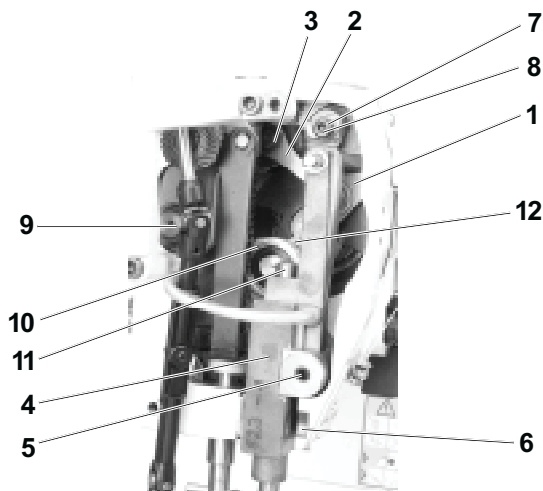

3.2 Needle and thread mechanism

3.2.1 Description

The take-up lever (1) is mounted in ball bearings, both at the spot of its suspending on the connecting rod (2) and in the mounting on the loop (12). The take-up lever is of aluminum and is provided with a stuck-in eye for two threads.

The connecting rod (2) is mounted on the eccentric pin (3). The needle rod holder (4) is mounted through the pivot (5) in the arm (6). In the upper part, the needle bar holder (4) is fixed in its correct position with the screw (8) in the pin (7) fastened on the machine arm.

The connecting rod (10) of the needle bar (11) on the loop (12) is mounted in a ball bearing and it is slidingly mounted on the needle bar carrier. The mechanism is lubricated by means of a central-wick lubricating system.

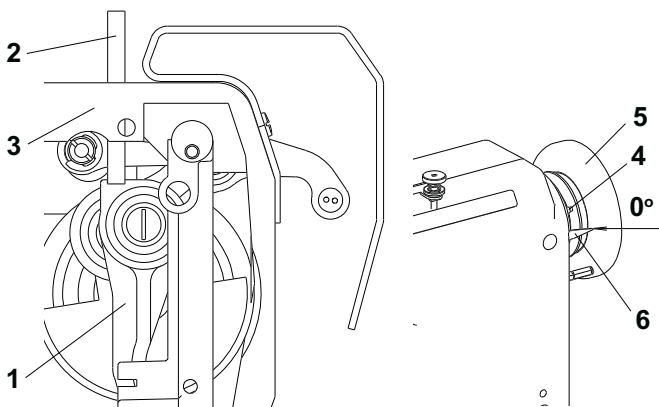

3.2.2 To check the handwheel angular adjustment

The handwheel (5) must be situated in its precise position relative to the needle and thread mechanism. This position is given by a pin (2), which locks the connecting rod of the needle rod (1) through a hole in the arm (3). In this position, the indicator (6) of the handwheel must show „0“. The position is fixed by the handwheel screw (4) contacting a small flat surface provided on the upper shaft.

The correct adjustment of the angular position has been carried out at the producer's.



Caution ! Danger of injury!

Switch off the main switch! Before starting the setting operation, wait until the motor stops!

3.2.3 Height setting of the needle bar

At the moment, when the hook point passes around the needle, the upper edge of the needle eye must be about 1 mm below the hook point. In an opposite case, it is necessary to set the height of the needle bar as follows:

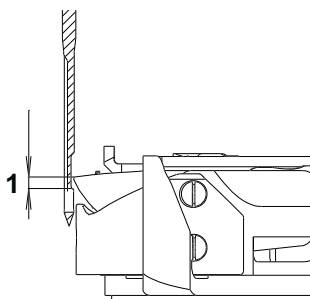

Caution ! Danger of injury!

Switch off the main switch! Before starting the setting operation, wait until the motor stops!

- Remove the front guard.
- Loosen the screw (1) of the needle bar carrier
- Set the correct height of the needle bar and tighten anew the screw (1).



Caution !

An incorrect setting of the needle bar height may cause the striking of the hook point against the needle.

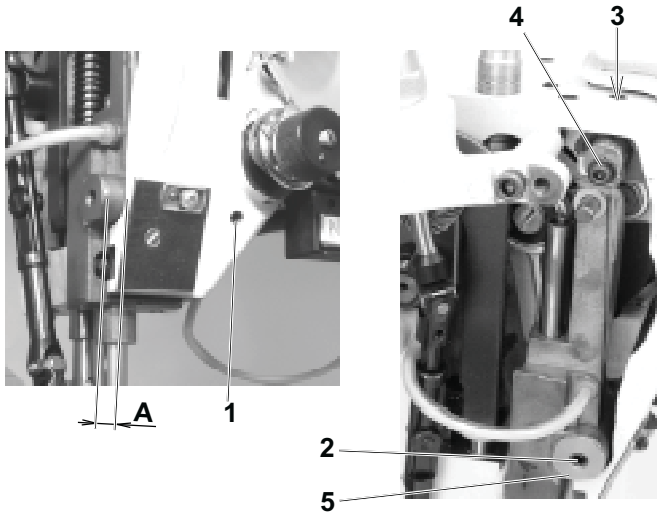

3.2.4 Side setting of the needle bar holder

The correct position of this holder is in such case, when the needle bar is lined up with the presser-foot bar. The needle bar holder can be set as follows:



Caution! Danger of injury!

Switch off the main switch! Before starting the setting operation, wait until the motor stops!

- Loosen the screw (1) of the pin (2).
- Loosen the screw (3) of the guide pin (4).
- In shifting the pin (2) set the needle bar holder on the measure „A“ = 8 mm (distance between the front face of the arm and the front face of the safety bolt (5) of the needle bar holder) /at the same time the pin (4) shifts/.
- The guide pin (4) is to be set in such a way that the needle bar holder moves easily.
- Tighten the screws (1 and 3).

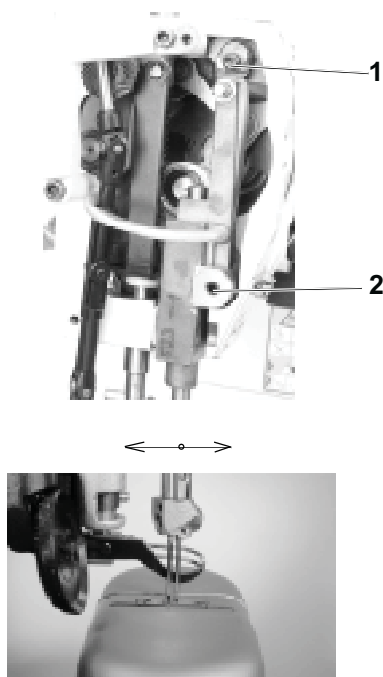

3.2.5 Setting the needle (the needle bar holder)

When moving the needles through the throat plate, the needles must pass through the centre of the holes in the insert of the throat plate.



Caution ! Danger of injury!

Switch off the main switch! Before starting the setting operation, wait until the motor stops!

- Using the handwheel, set the needles in the position, when the needles starts passing into the the throat plate.
- Loosen the screw (1) fixing the needle bar holder.
- Moving the needles in the longitudinal direction – around the pin (2), set the needles into the axis of the holes.
- Tighten the screw (1) and check the given setting.



Caution!

A faulty setting may cause bending or breaking of needles against the throat plate insert.

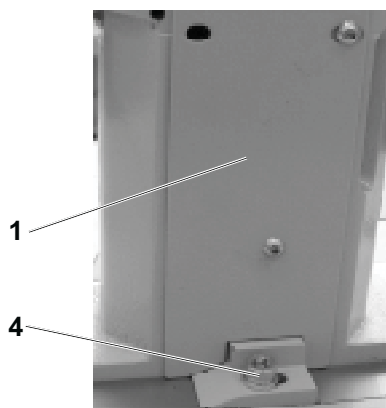
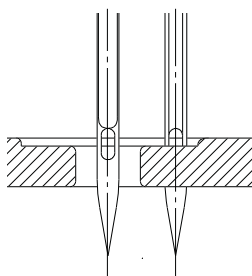
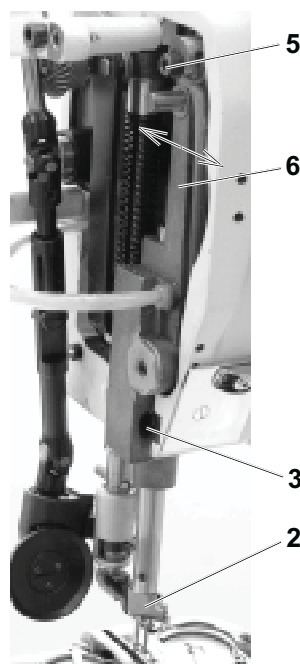
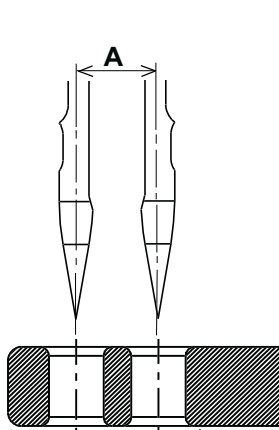
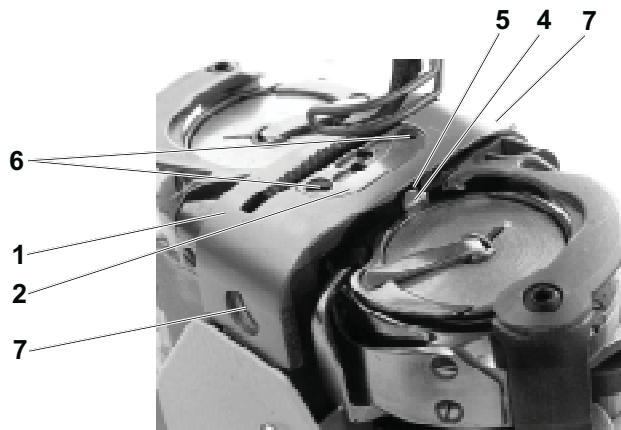
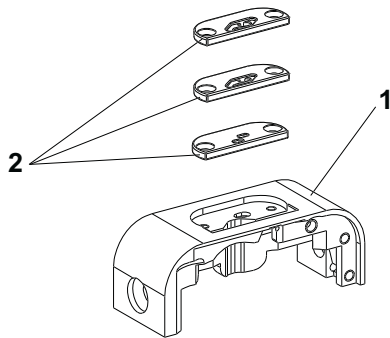

3.3 Throat plate and its post

3.3.1 Description

The throat plate (1) is always for the given stitch width of needles and universal for all respective categories of sewing (see Tab. sewing equipments - Spare parts list).

In the throat plate there is mounted an exchangeable throat plate insert (2). For each stitch width of needles, it is possible to supply several throat plate inserts differing one from another by the width of the piercing hole.

3.3.2 Mounting and removing the throat plate and its insert

When mounting the throat plate (1), the fingers (4) of the bobbin case must fit into the recess (5) of the throat plate. When dismantling the throat plate insert (2), it is necessary to unscrew both screws (6) and to remove the throat plate insert.



Caution! Danger of injury!

Switch off the main switch! Before starting the setting operation, wait until the motor stops!

- Turn the fingers (4) in the sense towards the throat plate (1).
- Place the throat plate (1) onto the post.
- Screw in the screws (7).
- Mount the throat plate insert (2).
- Tighten the screws (6).
- When removing the insert, proceed in an inverse sequence.

3.3.3 Side setting of the throat plate post and setting of the needle bed shifting

The throat plate post (1) and the needle holder (2) are to be mutually positioned in such a way, so that, with the given stitch width "A", both needles pass through the centres of the needle penetration holes.



Caution! Danger of injury!

Switch off the main switch! Before starting the setting operation, wait until the motor stops!

- Loosen the screw (3) of the needle bar carrier.
- Shift the needle bed (2) in such a way, so that the required stitch width of needles „A“ is attained.
- Tighten up the screw (3) and check up the setting.
- Loosen the screws (4) /from the rear side of the post too/.
- Shift the post (1) in the right direction in such a way, so that both needles pass through the centres of the needle penetration holes.
- Tighten up the screws (4) and check up the correctness of setting.

3.3.4 Setting the needle (the needle bar holder) in the direction of sewing (fine setting)



Caution! Danger of injury!

Switch off the main switch! Before starting the setting operation, wait until the motor stops!

- Loosen the screw (5).
- In turning the needle bar holder (6), set the needle against the centres of the needle penetration holes.
- Tighten up the screw (5) and check up the setting.



Caution!

A faulty setting may cause bending or breaking of needles against the throat plate insert.

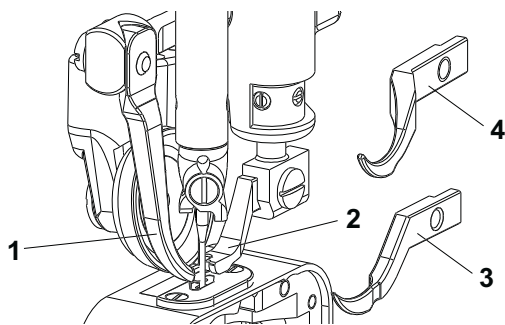

3.4 Front and rear guides of needles

3.4.1 Description

The front guide (1) and the rear guide (2) are used together for stitch widths of a tandem arrangement. With the sewing categories 300 and 400, it is possible to replace these guides by one guide (4) /the rear guide and the side guide in one guide/.

For stitch widths with needles side by side, the rear guide (3) is used only. All guides serve for holding the sewn material against the throat plate. In addition to this, they contribute to a as well and protect the needles in guiding them into the piercing holes.

3.4.2 Setting the front guide

The front guide is universal for tandem stitch widths and for all categories of sewing. It should be set in such a way that, from the point of view of the operator, it protects the right needle from the left-hand side. In the that, when backward stitching, it could not negatively influence the stitch locking. Its correct height is set up according to the sewn material 1-2 mm above the bottom edge of the feeding wheel. For harder materials, it is set a bit lower and inversely.



Caution! Danger of injury!

Switch off the main switch! Before starting the setting operation, wait until the motor stops!

- Loosen the screw (4) and set the correct height of the guide (1). Tighten then the screw.
- Loosen the screw (5) and set the guide (1) in the direction of sewing in front of the left needle at the moment, when the needle starts piercing the material and set, at the same time, the side clearance between the guide and the right-hand needle, tighten then the screw.
- Check up the influence of the setting on the stitch locking.

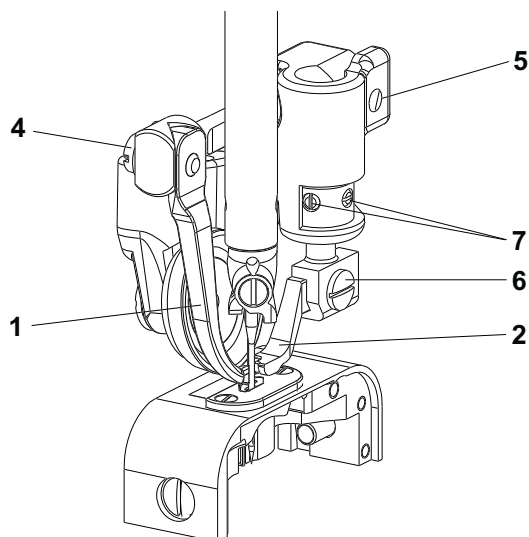

3.4.3 Setting the rear guide

For different stitch widths of needles there is always used, for all sewing categories, the respective guide (in each sewing set there is supplied a corresponding guide). The rear guide protects the left needle from the right-hand side. It is to be set in such a way in the direction of sewing that it favourably influences the stitch locking even when sewing the radii. Its correct height is set 1-2 mm above the bottom edge of the feeding wheel, namely according to the hardness of the sewn material.



Caution! Danger of injury!

Switch off the main switch! Before starting the setting operation, wait until the motor stops!

- Loosen the screw (6) and set the guide (2) in the direction of sewing behind the right needle at the moment when the needle leaves the sewn material, tighten up the screw.
- Loosen the screws (7) and set the guide in its correct height and, at the same time, set the side clearance between the guide and the left needle, tighten up the screw.
- Check up the influence of setting on the stitch locking.

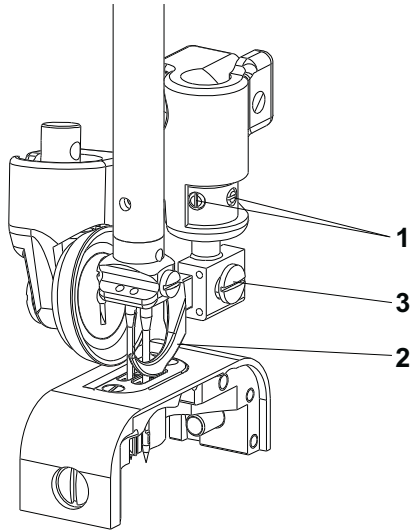

3.4.4 Setting of the rear and side guides

With the sewing categories 300 and 400, it is possible to replace the front and the rear guides by one guide. This is a variant, where the use of the front and of the rear guides does not enable attaining a satisfactory stitch locking. This guide is to be set in height 1-2 mm above the lower edge of the feeding wheel in accordance with the hardness of the sewn material. In the sewing direction and with regard to the clearance against the needle, the setting is to be done in such a way, so that the guide should not have any influence on the quality of the stitch locking.



Caution! Danger of injury!

Switch off the main switch! Before starting the setting operation, wait until the motor stops!

- Loosen the screws (1) and set the guide (2) in height, set the clearance between the needle and the guide, tighten the screws (1).
- Loosen the screw (3) and set the guide in the sewing direction, tighten the screw.
- Check the influence of the setting on the stitch locking.

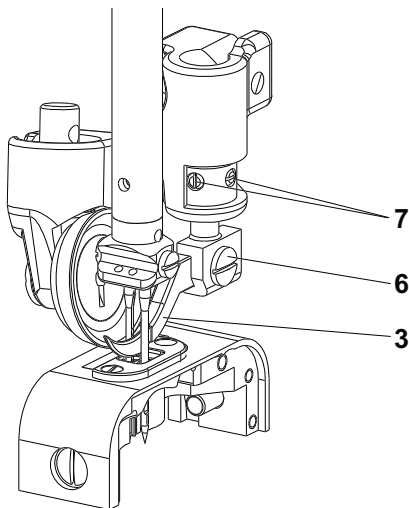

3.4.5 Setting the guide of the needles (stitch widths with needles, side by side)

The side setting of the guide is to be done starting from the axis of the stitch width of the needles, that is to say that the clearances between both needles and the guide must be the same. The correct height of the guide is set up according to the sewn material, 1-2 mm above the bottom edge of the feeding wheel. In the sense of sewing, the guide is to be set in such a way that the contact of the guide with the material is at the same spot as the contact of the feeding wheel with the material.



Caution! Danger of injury!

Switch off the main switch! Before starting the setting operation, wait until the motor stops!

- Loosen the screws (7) and set the guide (3) into the axis of the stitch width of the needles and set the guide in its correct height, tighten the screws.
- Loosen the screw (6) and set the guide in the direction of sewing according to the feeding wheel, tighten the screw.
- Check up the influence of setting on the stitch locking.

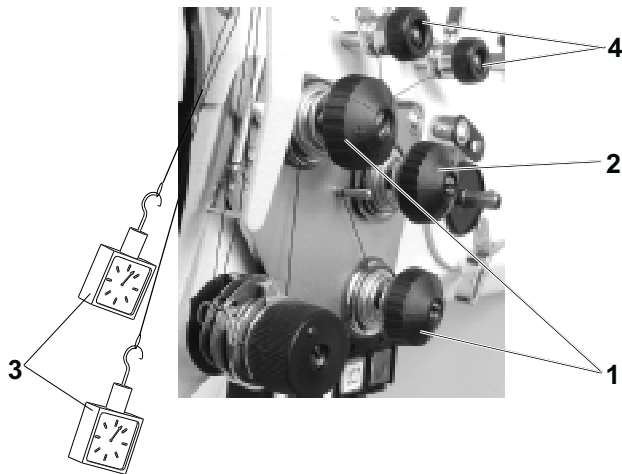
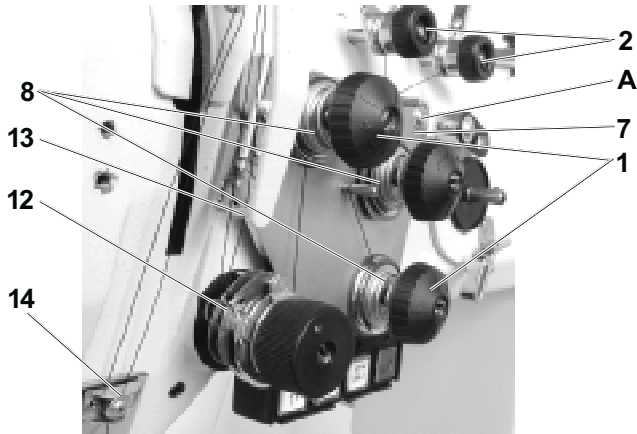
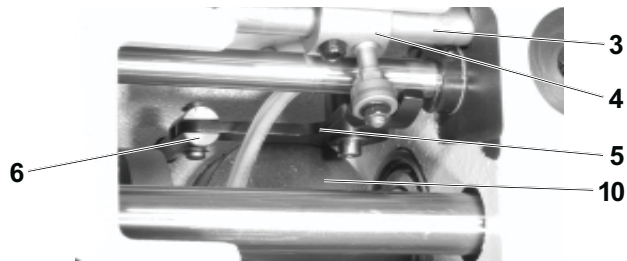

3.5 Thread tensioners and limiter

3.5.1 Description

The main tensioners (1) serve for producing the thread tension when tightening stitches. The auxiliary tensioners (2) prevent the pulling out of the thread after having ended the thread trimming when removing the sewn material, when the threads are being passed through this material and when the main tensioners are relieved. The main tensioners are relieved by means of a mechanism which is controlled by the presser foot lifting shaft (3), on which the lever (4) with a pulley is attached. The motion is then transmitted by the lever (5) and the tie rod (6) on the thread tensioner plate (7) whose displacement (motion) relieves the thread tensioner springs (8). In machines provided with a thread trimming device, the main tensioners (1) are relieved as well upon the switching on of the electromagnet (10) whose electromagnetic field will attract the thread tensioner plate (7). The mechanism of the adapting spring (12) maintains the upper thread in its tensioned state when passing through the hook and when entering the needle into the sewn material. The thread limiter (13) limits the length of the thread fed by the take-up lever when moving from the upper to the bottom dead centre to get a controlled passing of the thread through the hook. The auxiliary guide (14) maintains the upper thread in front of the needle in a tensioned condition and helps against pulling the thread from the needle after thread trimming.

3.5.2 Setting the tension of the main and auxiliary tensioners

The tension of the main tensioners of both threads is regulated by the nuts (1) and by the nut (2) of the common tensioner. The force of tensioning the thread is measured by the dynamometer (3) as it is shown on the illustration. The size of this force differs according to the category, and its orientation value is indicated in the par. 11.2.

The tension of the auxiliary tensioners is regulated by the nuts (4). It must be the least possible, but sufficient for getting out the threads from the sewn material under the pressing element after having ended the trimming operation, without leaving the tensioners.

3.5.3 Setting the tensioning mechanisms of the main tensioners

In the rest position of the tensioners, when pushing the plate of the tensioners on the spot "A" 3.5.1, this plate must have the so-called dead travel of about 0,5 mm. At this lifting, the tension discs of the tensioners must not be relieved. This can be attained by a suitable shaping of the relieving disc of the tensioners - this has been set up in the manufacturing factory. In the maximum opened position of the tensioners, the plate of the tensioners, when pushing it at the spot "A" 3.5.1, must still have the minimum lifting. This can be attained when axially shifting the lever (3) with the roller (5) on the shaft (4). The disengagement of the main tensioners must be coordinated with the top roller lift. To achieve this, turn the lever (3) with the roller (5) on the shaft (4). The movement of the roller (5) on the slanting surface (6) of the lever (7) disengages the tensioners. In this way, also a lag of the upper thread tension disengagement after the top roller lift can be obtained.



Caution ! Danger of injury!

Switch off the main switch! Before starting the setting operation, wait until the motor stops!

- Remove the rear cover with the top roller lift magnet.
- Loosen the screws (1) and (2) of the lever (3).

- In the rest state of the machine (with not relieved tensioner discs) set the lever (3) in turning it slightly on the shaft (4) to a position in which the roller (5) of the lever (3) is in contact with the slanting surface (6) of the lever (7) and is about 0.1 mm distant from the flat surface (8) of the lever.
- At the maximum lift of the top roller, the roller (5) moves on the flat surface (9) of the lever (7); in this condition, there must be a minimal play at the tensioner plate lift (when pushing qat the spot "A" (3.5.1), the plate must still have a minimum lifting - between the roller (5) and the surface (9) there is a minimum clearance). Retighten the screws (1) and (2), check the play, and correct it in case of need.

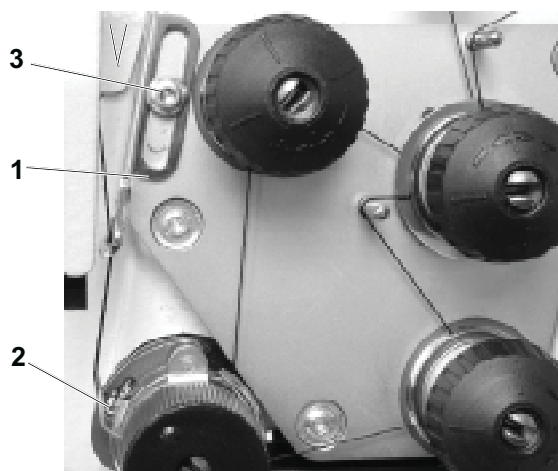
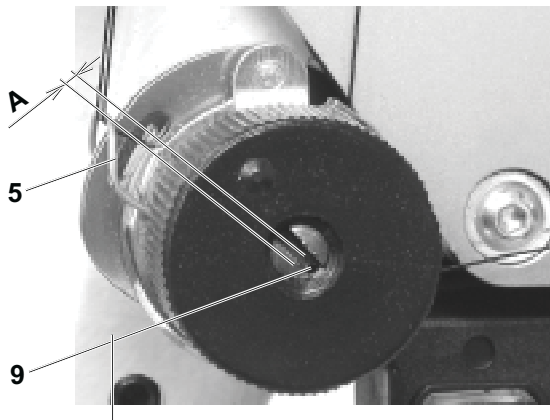
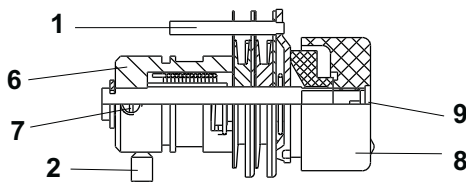
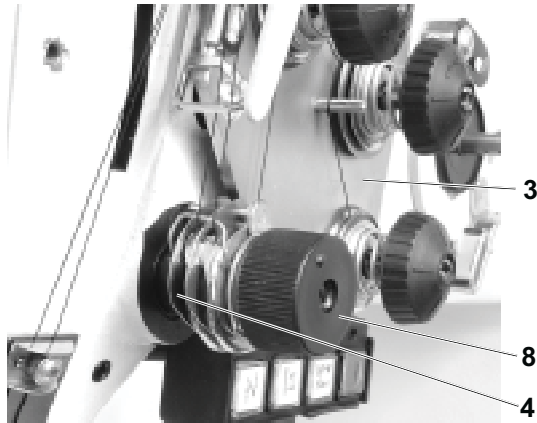

3.5.4 Setting the adapting spring

The mechanism of the adapting spring is in the machine arm set by the pin (1) and fixed by the screw (2). The axial adjustment shall ensure that the surfaces of the parts (3) and (4) are aligned (the threaded thread must in no place break on edges). The initial position of the adapting spring (5) shall ensure that "B" = 1 to 1.5 mm (see the Figure).



Caution! Danger of injury!

Switch off the main switch! Before starting the setting operation, wait until the motor stops!

- Loosen the screw (2) and take the mechanism out of the machine arm.
- Turning the body (6) relative to the pin (1), set the required initial position of the adapting spring /the screw (7) has been set at the producer's so as to permit the turning movement of the body (6) the screw must not be fully tightened/.
- During the installation of the mechanism into the machine arm take care of the axial adjustment of the mechanism.
- Retighten the screw (2) and check the adjustment.
- Loosen the nut (8) of the mechanism, insert a screwdriver into the notch of the screw (9) and set the required value of the adapting spring. By turning the screw clockwise you increase the spring force, and vice versa.
- Retighten the nut (8) and check the function of the adapting spring.

3.5.5 Setting the thread limiter

The thread limiter is to be set in such a way that, when sewing and passing the thread through the most distant point of the hook, the spring (2) shifts by about 1/4 to 1/2 length of its total length. This means that the thicker will be the sewn material and the longer will be the stitch length, the more will be the limiter shifted in the sense of the arrow and inversely.



Caution! Danger of injury!

Switch off the main switch! Before starting the setting operation, wait until the motor stops!

- Tighten the screw (3).
- Set the thread limiter (1) so as to ensure a minimum motion of the adapting spring (2) when the thread passes around the bottom of the hook.
- Tighten the screw (3).

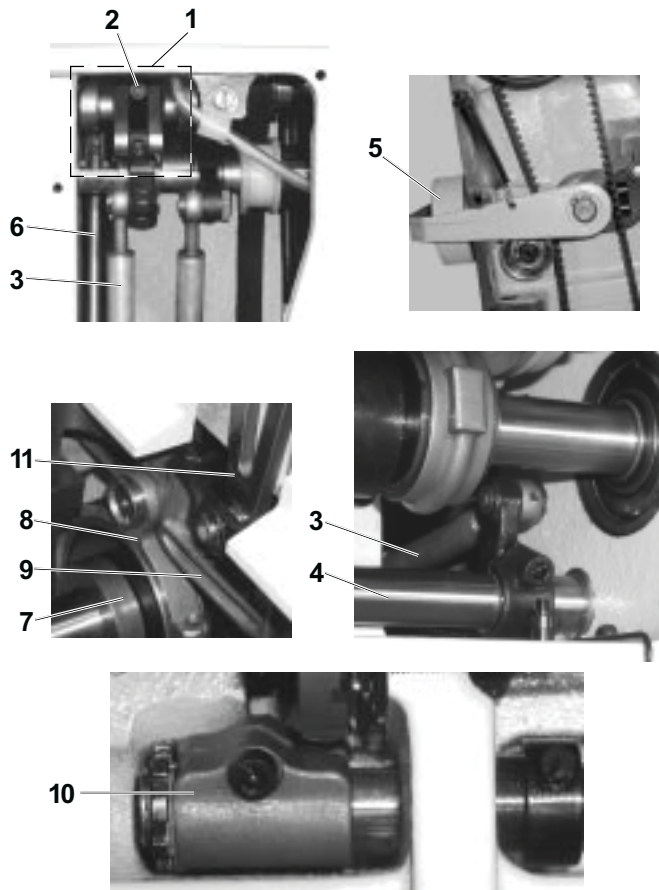

3.6 Feeding mechanism of the bootom feed

3.6.1 Description

The bottom feed is formed by two independent mechanisms necessary for attaining an elliptical way of the feeder. The feeding mechanism for the horizontal component of the feeder movement is formed by the lever mechanism (1) – the mechanism of the stitch length. This is driven from the main upper shaft through the eccentric with the connecting rod (2). The feeding movement is then transmitted by means of the draw bar (3) on the oscillating shaft (4) and, through the lever (10), on the feeder carrier (9). The stitch length (the size of the horizontal component of the feeder movement) is to be set using the button (5) through the leverage (6) onto the lever mechanism (1).

The feeding mechanism for the vertical component of the feeder movement is formed by the lifting eccentric (7) on the bottom shaft. The movement is transmitted by the connecting rod (8) through the feeder carrier (9) and, further, through the balance beam (11) onto the feeder.

3.6.2 Stitch length mechanism

3.6.2.1 Setting of the horizontal component of the feeder movement

(setting of the upper feeding eccentric)

The feeding eccentric (1) must be angularly set in such a way, so that the feeding movement for the horizontal feeding component is delayed in phase against the needle movement. This requirement is fulfilled when setting the 90° angle on the handwheel (2), when the setting bar (3) is pushed into the eccentric (1) and leans from above against the feeding shaft (4).



Caution! Danger of injury!
Switch off the main switch! Before starting the setting operation, wait until the motor stops!

- Set the angle 90° on the handwheel (2) and fix it with the screw (5) which is component part of the accessory of the machine (tighten it with care).
- Loosen the gripping joints of the levers (6) and (7).
- Turn the feeding shaft (4) in such a way, so that the recesses (flats) point towards the bedplate (owing to the unambiguous setting of the eccentric by means of the setting bar).
- Insert the setting bar (3) into the eccentric (1) and prop it from above against the feeding shaft (4).
- Shift axially the eccentric (1) on the shaft into its extreme positions and place it in the middle.
- Tighten the screws of the eccentric (1) to the maximum (one screw first and, after having turned slightly the hand-wheel, the second screw as well).
- Turn the feeding shaft (4) back into the position for setting the leverage in such a way, so that the levers (10) of the mechanism pass in the spots of the recesses.
- Tighten the gripping joints of the levers (6) and (7).
- Test the sufficient clearance in the recesses of the feeding shaft (4) and, using the levers (10) with the maximum stitch length forward and rearward – push against the reverse stitching lever.
- Correct eventually the position of the feeding shaft.
- Check the position of the prop (11). In this machine provided with a bottom feed, the prop is mounted into the pits (A and B) as per the respective drawing.

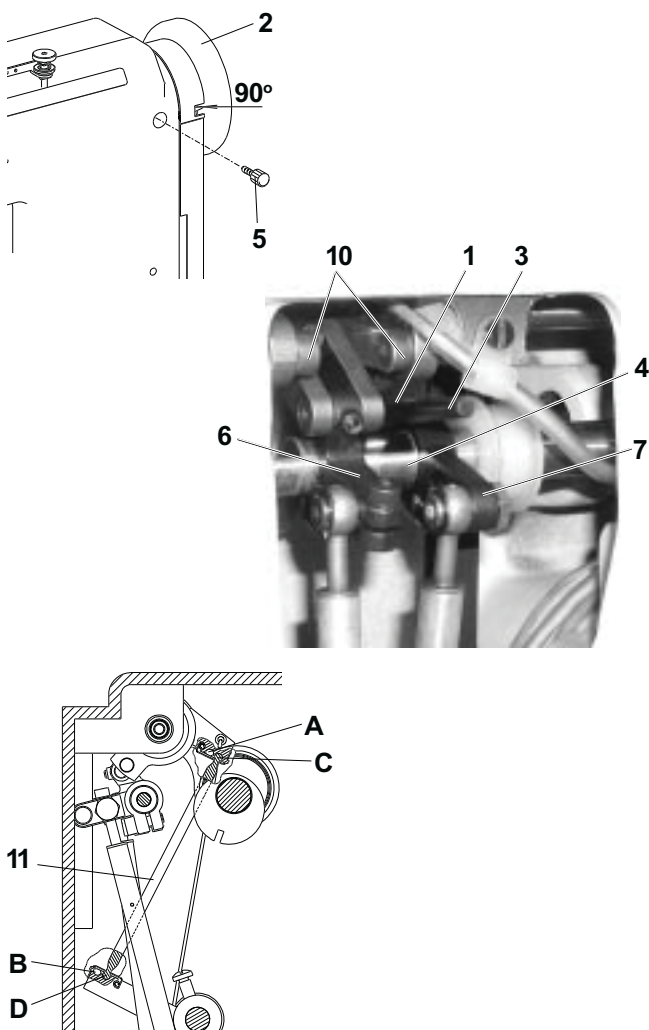

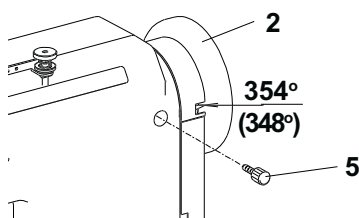
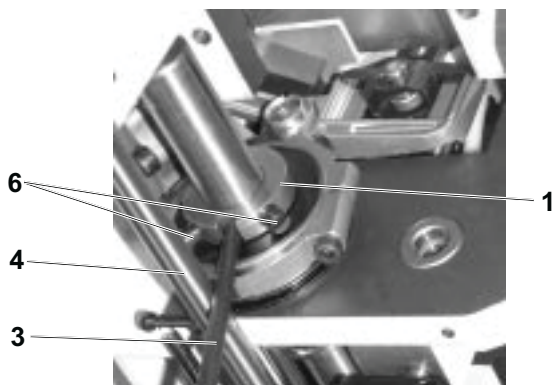

3.6.2.2 Setting of the vertical component of the feeder movement

The lifting eccentric (1) must be angularly set in such a way, so that the vertical movement of the feeder is delayed on phase against the movement of the needle. This requirement is fulfilled by the angle 354° on the handwheel (2) for the stitching categories 100 and 200, 348° suits for the stitching categories 300 and 400, when the setting bar (3) is inserted into the eccentric (1) and is propped against the shaft (4).



Caution! Danger of injury!

Switch off the main switch! Before starting the setting operation, wait until the motor stops!

- Set the value 354° (348°) on the handwheel (2) and fix it with the screw (5), which is a component part of the machine accessory (tighten it with care).
- Loosen the screws (6) of the eccentric (1).
- Insert the setting bar (3) into the slot of the eccentric (1) and prop it against the shaft (4).
- Tighten the screws (6).

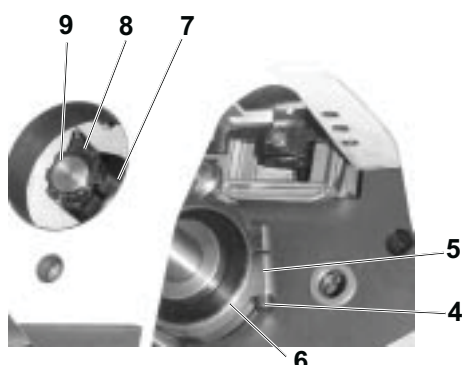
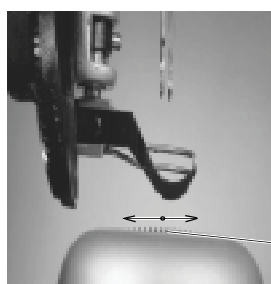
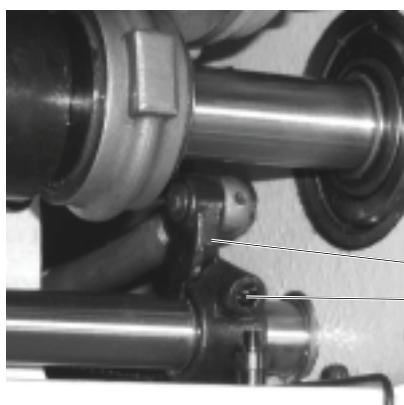

3.6.2.3 Setting of the feeder position against the throat plate

The correct position of the feeder is such when the feeder symmetrically moves in the slot of the throat plate in forward and backward direction and above and below the throat plate as well.



Caution! Danger of injury!

Switch off the main switch! Before starting the setting operation, wait until the motor stops!

- Using the handwheel, set the needle into its top dead centre (the feeder is in its maximum position above the throat plate).
- Loosen the screw (1) of the gripping joint of the lever (2) (this will separate the feeder from the source of the horizontal component of the feeder movement).
- In moving the feeder (3) in forward or backward direction, set the middle position of the feeder in the slot of the throat plate.
- Tighten the screw (1), check the movement of the feeder with the maximum stitch length (the gap in the throat plate slot must be the same before and behind the feeder)
- After having loosened the screw (4) of the lever (5), in turning the eccentric (6), we can change the height of the feeder above the throat plate (this has been set up on the manufacturing factory, it is being used in practice with the flatbed sewing machines)
- After having loosened the screw (7) of the lever (8), inturning the eccentric (9), we can change the longitudinal inclination of the feeder with regard to the throat plate /the optimum position has been set up in the manufacturing factory – the cutting of the of the eccentric (9) is situated at the spot of the cutting of the gripping joint of the lever (8)/.

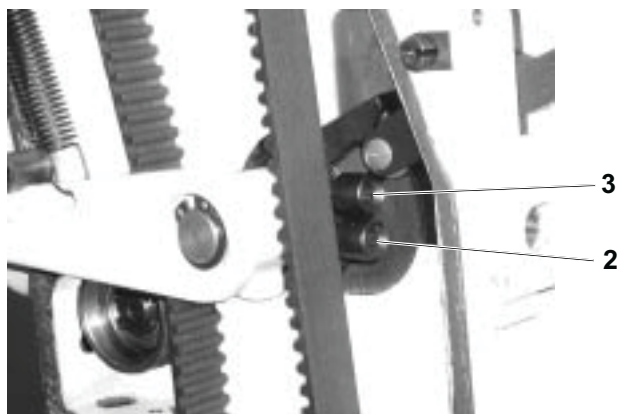
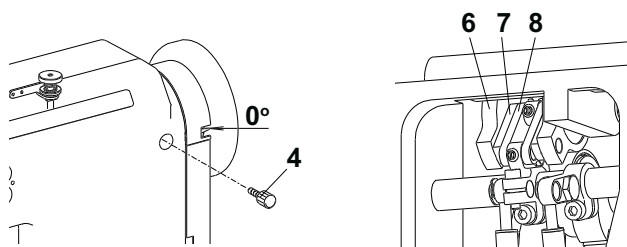
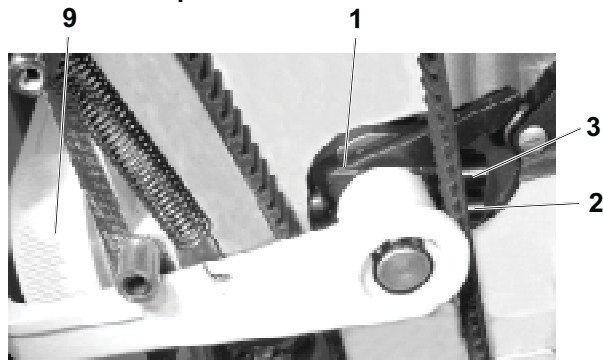
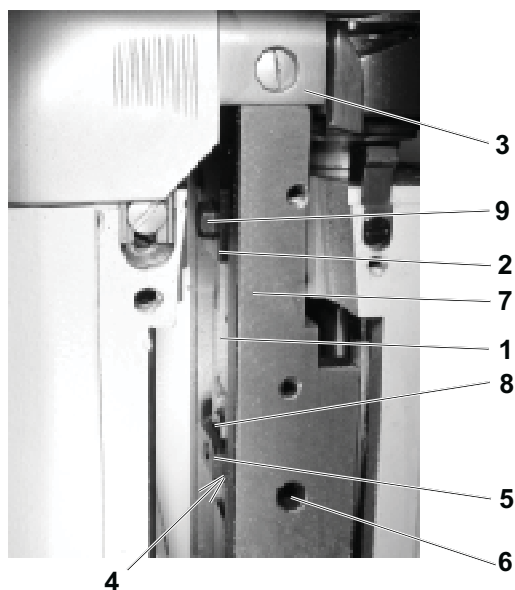
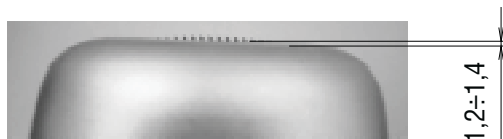

3.6.2.4 Setting of the height of the feeder teeth, setting of the feeding balance beam

The height of the feeder teeth is to be set according to the stitching category from 1,2 to 1,4 mm above the throat plate insert. The feeder balance beam (1) is laterally guided by the feeder (2) in the throat plate (3) and then, at the spot of the fulcrum, through the surfaces of the middle post (4) and of the pin (5) which is fixed in the middle post (7) by the screw (6). The balance beam (1) is guided on the pin (5) by means of the cube (8).



Caution! Danger of injury!

switch off the main switch! Before starting the setting operation, wait until the motor stops!

- Set the height of the feeder teeth after having done the previous setting (par. 3.6.2.3).
- Loosen the screw (9), adjust the height of the feeder teeth, tighten the screw.
- Set the lateral clearance of the balance beam at the spot of the fulcrum in shifting the pin (5) after having loosened the screw (6), tighten the screw (the balance beam movement should not drag).

3.6.2.5 Forward and rearward stitch length distribution (rough)

The cam (1) is to be set at the respective angle in such a way that the stirrup (6) is oriented in such a position, so that the connecting rods (7 and 8) are in a line with a thoroughly screwed in knob (9) and with turning the handwheel at 0°. This setting can be done only after having set the top eccentric according to the paragraph 3.6.2.1.



Caution! Danger of injury!

Switch off the main switch! Before starting the setting operation, wait until the motor stops!

- Set the zero stitch /screw in the knob (9) to the bottom of the cam (1)/.
- Set the angle 0° on the handwheel and lock it with the screw (4).
- Turn the screw (3) in the respective sense in such a way that the connecting rods (7 and 8) are in a line and tighten the screw (2).

3.6.2.6 Forward and rearward stitch length distribution (fine)

When setting the maximum length of the stitch, the forward and the rearward stitch length must be equal with the maximum error of $\pm 5\%$. This setting is only feasible after having set the bottom feeding /par. 3.6.2/ and after having set the feeding of the driven top roller /par. 3.7/.



Caution! Danger of injury!

switch off the main switch! Before starting the setting operation, wait until the motor stops!

- Set the maximum stitch length .
- Place a suitable material under the presser foot and mark therein the forward and the rearward stitch length.
- With an unequal length of the stitch, proceed to the correction of setting by turning the screws (2 and 3). When tightening the screw (3), the forward length of the stitch is shortened and inversely. When tightening the screw (2), the forward stitch length is lengthened.
- Loosen always one screw and tighten thereafter the other one.

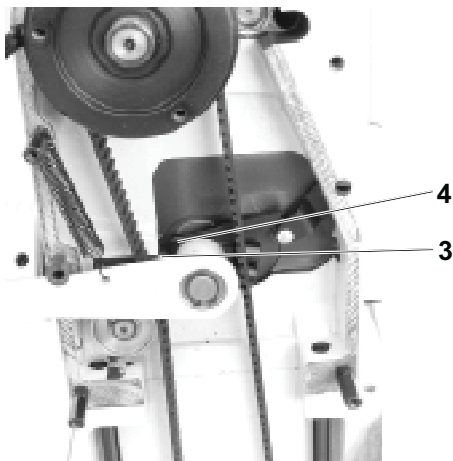

3.6.2.7 Setting the control knob (including the stitch length limitation)

The control knob (1) is to be set up in such a way that, when turning it in counterclockwise sense up to the stop, the maximum stitch length valid for the given sewing category is attained (cat. 1: 3 mm, cat 2: 5 mm, cat. 3 and 4: 7 mm). The scale of the control knob is to be oriented in such a position, so that the scale end corresponds to the maximum stitch length, excepting the first sewing category, where the stitch length of the indicator is 3 mm.



Caution! Danger of injury

Switch off the main switch! Before starting the setting operation, wait until the motor stops!

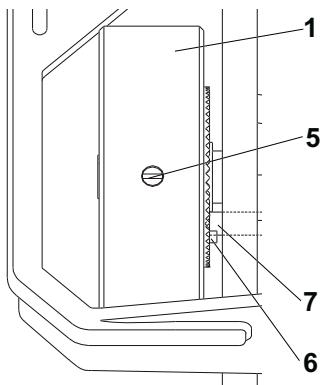
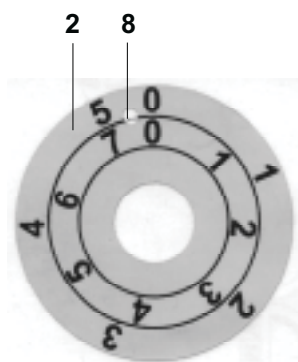

- Screw in the screw of the control knob in such a way, that the spherical surface of the screw (3) bears on the seat of the cam (4).
- Loosen the screw (5) and turn the control knob in the clockwise direction, until the pin (6) of the knob (1) bears on the pin (7). Tighten firmly the screws (5).
- Turn the knob in the counterclockwise direction up to the stop, when the pin (6) of the knob (1) bears on the pin (7).
- In a sewing test check up the length of the stitch, if this corresponds to the maximum stitch length valid for the given sewing category.
- If the stitch is longer, loosen then the screws (5) and turn the knob in the clockwise direction and inversely. Tighten firmly the screws (5).
- Insert a screwdriver into the hole (8) of the scale (2) and adjust the scale in such a way that the maximum length on the scale is against the marking of the stitch length on the machine arm.
- For the sewing category 1, set the control knob (1) on the stitch length of 3 mm and check it by a sewing test.
- Loosen the screws (5) and turn the control knob (1) in the counterclockwise direction, until the pin (6) of the knob (1) bears on the pin (7). Tighten firmly the screws (5).
- Put a screwdriver into the hole (8) of the scale (2) and adjust the scale in such a way that the value of the stitch length on the scale against the marking on the arm is 3 mm.

3.6.2.8 Feeder replacement

The bottom feeder replacement (change of the stitching category according to the machine setting - see table 10.2 - machine setting - feeder - teeth pitch).



Caution! Danger of injury

Switch off the main switch! Before starting the setting operation, wait until the motor stops!

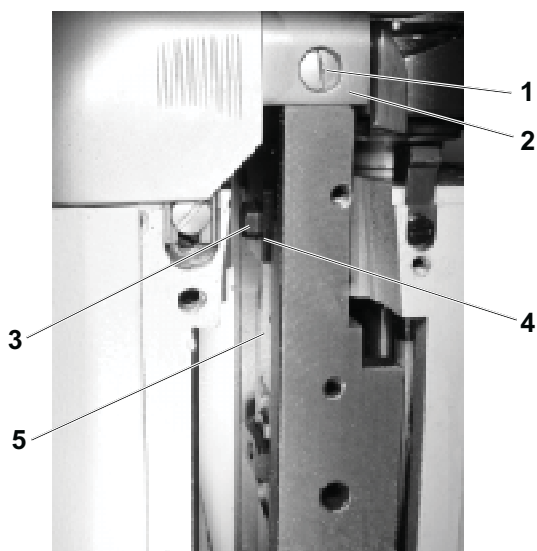

- Unscrew the screws (1) and remove the throat plate (2).
- Unscrew the screw (3) and remove the feeder (4)
- Put on the feeder (4), tighten slightly the screw (3)
- Put on the throat plate (2) according to the par. 3.3.2 and tighten the screws (1).
- Check the height of the feeder teeth, correct it eventually and tighten the screw (3).
- Check the lateral clearance of the balance beam (5) /the balance beam movement should not drag/.

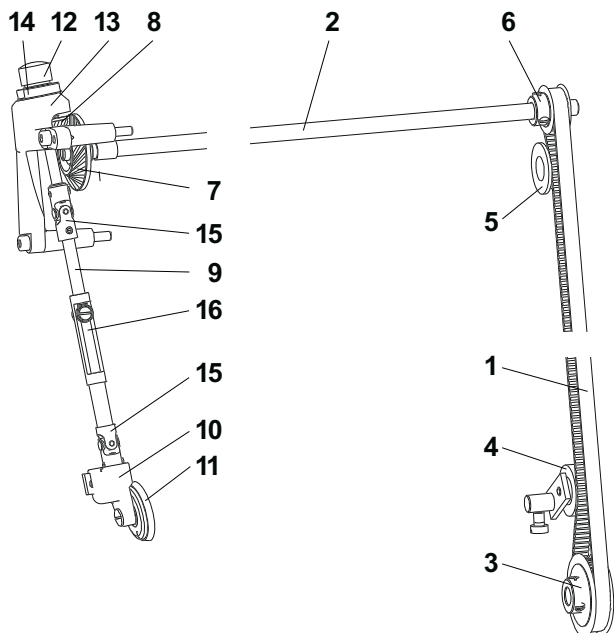

3.7 Feeding mechanism of the top roller

3.7.1 Description

The starting movement for the drive of the top roller feeder is the bottom feeding shaft. From this shaft, the movement is transmitted by the indented belt (1) onto the top feeding shaft (2). A component part of the transmission by indented belt is the pulley (3), the tensioning roller (4), the roller (5) and the pulley (6). Starting from the shaft (2), the movement is further transmitted through the wheels (7 and 8) onto the articulated shaft (9). From this articulated shaft, the movement is transmitted by a cone transmission, situated in the holder (10), onto the feeder wheel (11). The shaft of the wheel (8) is mounted in the screw (12) on bearings. The articulated shaft (9) contains two joints (15) and a telescopic part (16). Both these elements secure the lifting and the tilting of the top roller.

3.7.2 Feeding clutch

3.7.2.1 Description

The feeding clutch serves for changing the oscillating motion to the rotating one. It is formed by the clutch cover (1) which is locked in the bedplate using the pin (2), by the clutch star (4) driven by the draw bar (3) from the feeding mechanism and by the carrier disk (5) which is firmly connected with the shaft (6). The draw bar (3) imparts the clutch its oscillating motion. The clutch is being engaged by means of the wedge (7) on the connecting rod (8) through the eccentric (9) which is situated on the bottom shaft (10). In the position, when the wedge is disengaged, the star (4) is pulled out from its friction engagement with the lining of the carrier disk (5) by means of an elastic washer (11). The disk lining (5) is then pushed by the flat profiled spring (12) against the clutch cover (1). In this position, the shaft (6) does not perform any movement. In the position, when the wedge is engaged, the star (4) is pushed against the lining of the disk (5) and, at the same time, the connection with the clutch cover (1) is disengaged and the oscillating motion from the connecting rod (3) is transmitted to the rotating motion of the shaft (6). During a short moment, when engaging and disengaging with the carrier disk (5), both the cover (1) and the star (4) are engaged, namely in the extreme dead centre of the connecting rod (3). The clutch change over is to be set in tightening or loosening the nut (13).

3.7.2.2 Setting of the feeding pitch

The lever (1) transmitting the feeding motion by means of the connecting rod (3) onto the feeding clutch must be set in such a way, so that, in the bottom dead centre of the needle, the axis of the star part (2) is in the axis of the screw (4).



Caution! Danger of injury!

Switch off the main switch! Before starting the setting operation, wait until the motor stops!

Lever (1) displacement

- Loosen the screw (6).
- Set the maximum stitch length.
- Set the angle 180° on the handwheel.
- Unscrew the screw (5) and put the needle shank in its hole.
- Turn the lever (1), until the needle fits into the hole in the star part (2).
- Side set the lever (1) to the measure „A“ = 0.5 to 1 mm.
- Tighten the screw (6).
- Screw in the screw (5) and seal it with the Loctite cement.

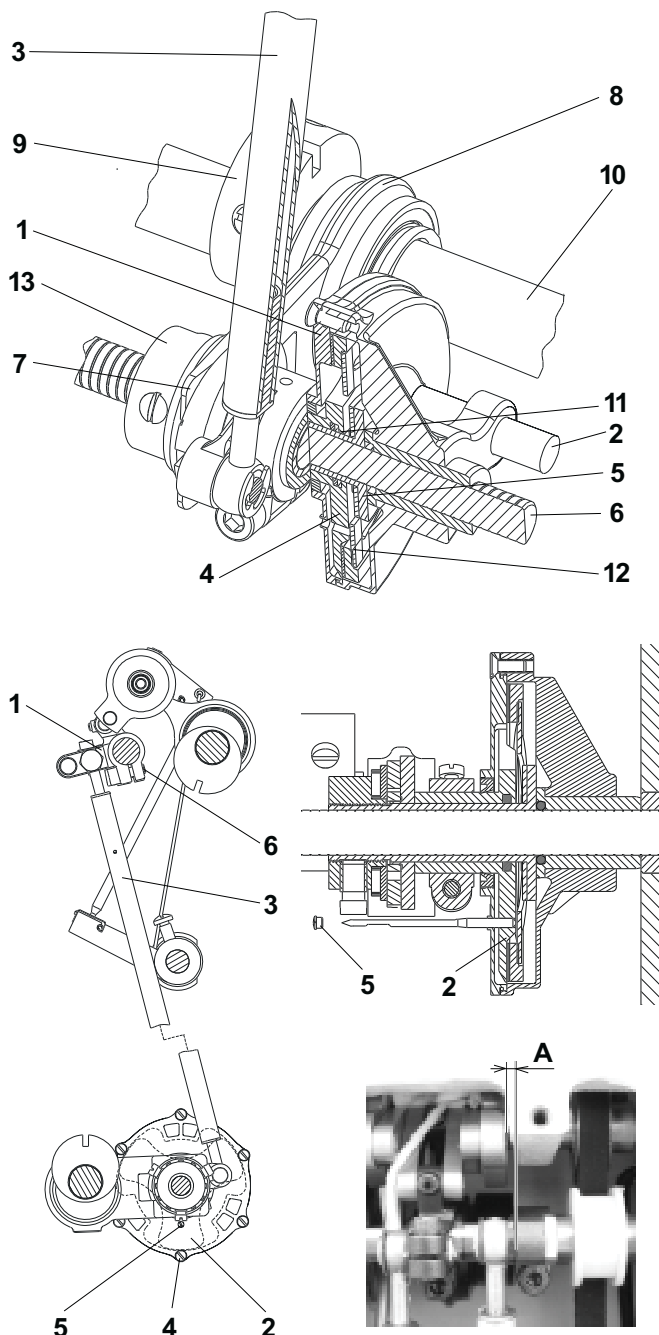

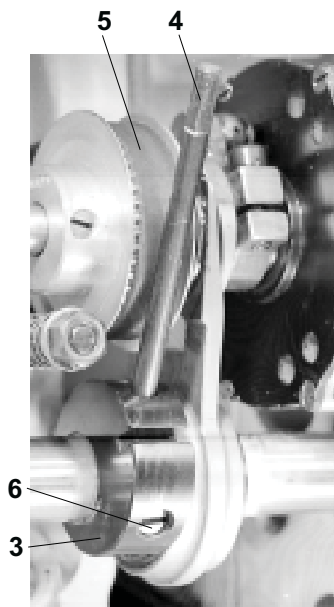
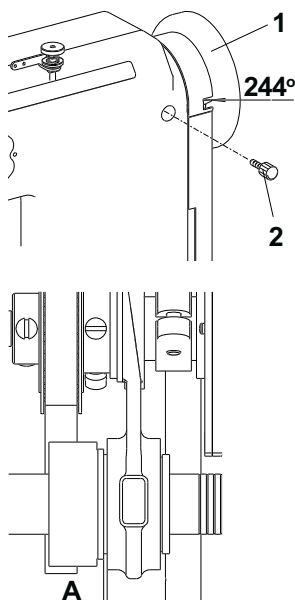

3.7.2.3 Setting of the lower eccentric

The rotation of the eccentric (3) must be delayed in phase against the rotation of the stitch length eccentric. This corresponds with the angle 250° on the handwheel (1) for the stitching categories 100 and 200, 244° is in correspondance with the stitching categories 300 and 400, when the setting pin (4), which is in contact with the toothed belt (5), is being inserted into the eccentric (3).



Caution! Danger of injury!

Switch off the main switch! Before starting the setting operation, wait until the motor stops!

- Set 250° (244°) on the handwheel (1) and lock it with the screw (2), which is included in the accessory of the machine (tighten it carefully).
- Put the setting stick (4) into the hole in the eccentric (3) and prop it from below against the indented belt (5).
- Set eccentric (3) axially.
- Tighten it the utmost the screws of the eccentric (6).
- By means of the handwheel, turn the eccentric (3) into the marked position and check in this position the clearance „A“ = 0.05, proceed eventually to its correction by a new side setting of the eccentric.

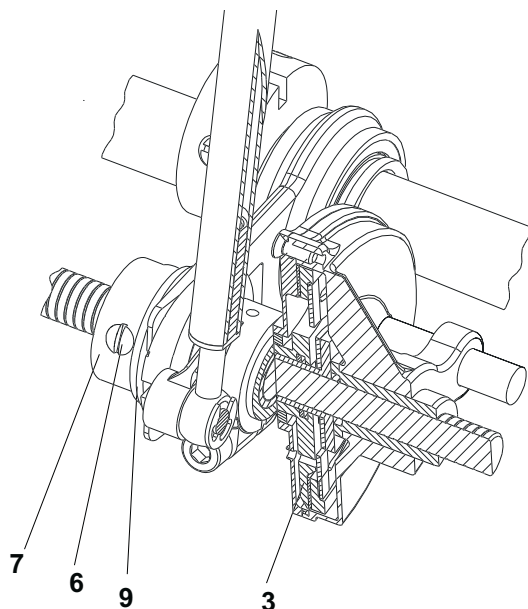
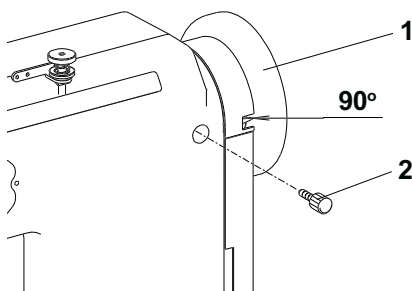

3.7.2.4 Setting the engagement and disengagement of the clutch

The nut (7) must be laterally set in such a way, so that the clutch change over occurs in the moment, when the star (3) does not move, which means, when it is in a dead centre of its oscillating motion. This corresponds to the angle 90° on the handwheel.



Caution! Danger of injury!

Switch off the main switch! Before starting the setting operation, wait until the motor stops!

- Loosen the screws of the indented pulley of feeding and shift it to the left.
- Set the maximum stitch length.
- Set the angle 90° on the handwheel (1) and lock it with the screw (2), which is included in the accessory of the machine (tighten it carefully).
- Loosen three screws (6) in the nut (7) and unscrew it by 2 mm to the left.
- Tighten slowly the nut (7), until it strikes against the axial bearing (9). (At this moment, the tightening moment increases in jumps) and tighten the screws (6).
- Set the handwheel onto 85° and depress the reverse stitching lever, the roller presser foot must turn against the stitching direction. The feeder exerts too a reverse motion. Turn slowly the handwheel and, at the same time, depress the reverse stitching lever. When attaining about 90°, the reverse stitching lever stops its engagement and the roller presser foot stops turning at all. In the handwheel position of 95° (and more), the roller presser foot may not turn at all. The reverse stitching lever starts engaging anew. When the clutch changes over too fast, turn a bit the nut (7) to the right and inversely.
- Tighten the screws (6).
- Return the indented pulley in its original place according to the paragraph 3.6.3.

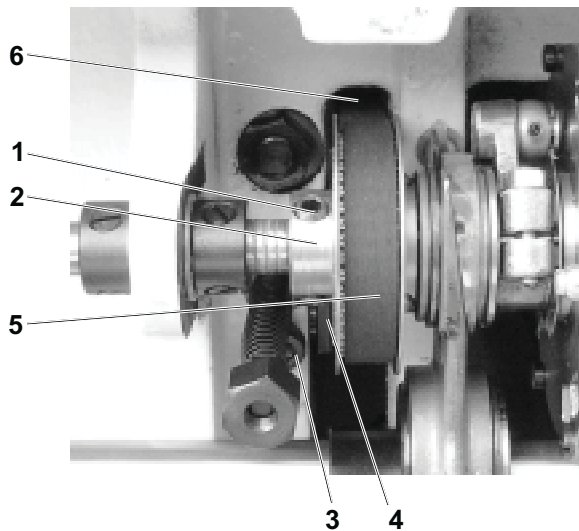

3.7.3 Side setting of the indented lower pulley

The pulley must be set up in such a way that the belt passes through the centre of the passing hole in the bedplate. The setting operation is to be done as follows:



Caution! Danger of injury!

Switch off the main switch! Before starting the setting operation, wait until the motor stops!

- Loosen the screws (1) of the pulley (2).
- Loosen the screw (3) of the tensioning roller (4)
- Set the pulley (2) in such a way that the belt (5) passes through the centre of the passing hole in the bedplate (6).
- Tighten the screws (1).
- Set the tensioning roller (4) axially in such a way that the belt (5) is set at the middle of the tensioning roller (4).
- Set the tensioning roller (see par. 3.7.5).
- Tighten up the screw (3) of the tensioning roller (4).

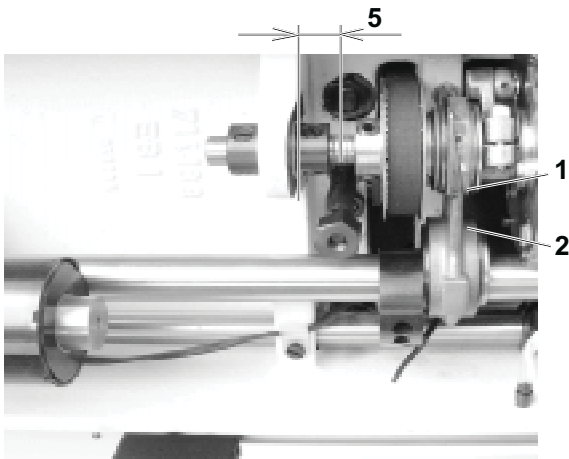

3.7.4 Side setting of the indented upper pulley

The pulley is to be set in such a way that the indented belt is not crossed and the pulleys are in line. The setting thereof is to be done as follows:



Caution! Danger of injury!

Switch off the main switch! Before starting the setting operation, wait until the motor stops!

- Loosen the screws (1) of the pulley (2).
- Set the pulley (2) in such a way that the distance of 5 mm is attained in accordance with the illustration.
- Tighten the screws (1).

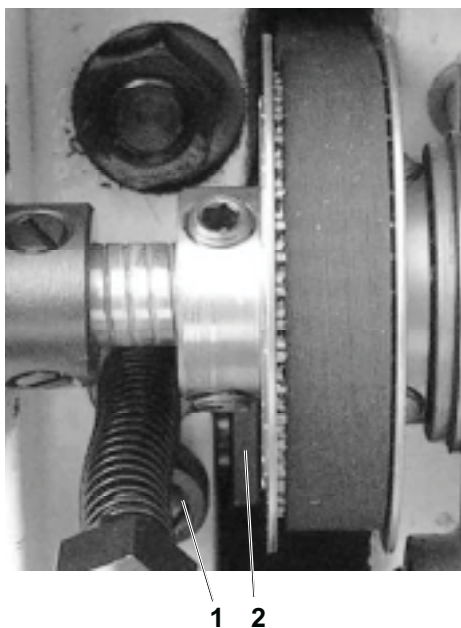

3.7.5 Setting the tensioning roller

The tensioning roller of the indented belt of the top feeding is mounted in a rotary way on the bedplate. The belt must be tensioned as needed in such a way that there is ensured the correct function of the transmission. Insufficient tension can cause skipping of the teeth, on the contrary, excessive tensioning enormously loads the mounting of the top shaft. The setting thereof is to be done as follows:



Caution! Danger of injury!

Switch off the main switch! Before starting the setting operation, wait until the motor stops!

- Loosen the screw (1) securing the lever of the tensioning roller (2).
- Tension the belt as needed (theoretically, in applying the force of 10 N in the middle of the belt with the deflection of 4 mm).
- Tighten the screw (1).

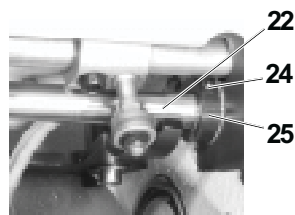
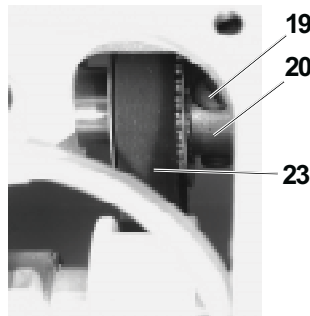
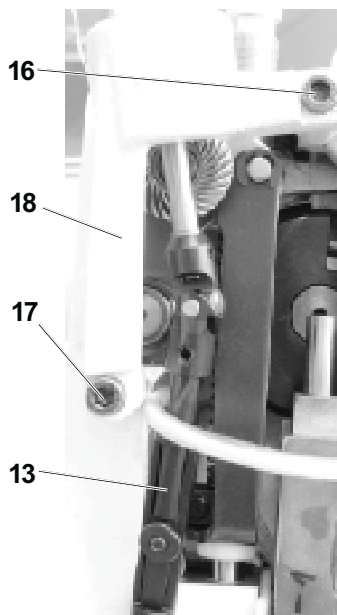
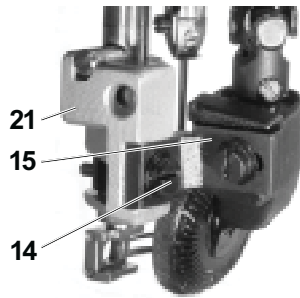
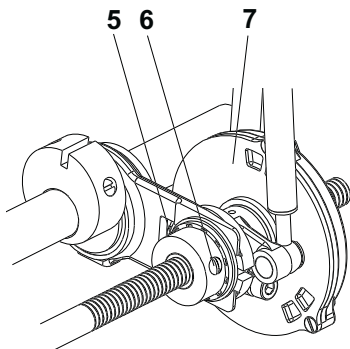
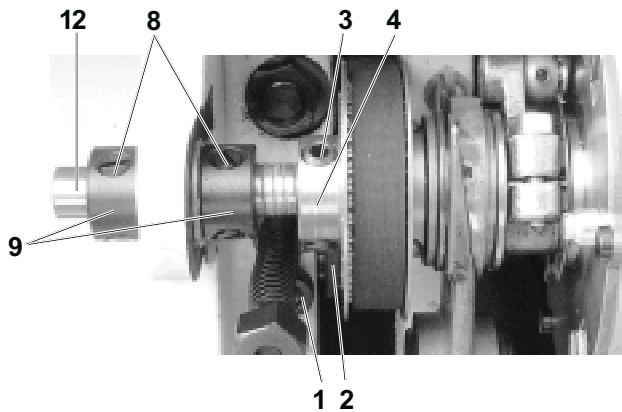

3.7.6 Replacement the indented belt

Before replacing the indented belt, the bottom feeding shaft is to be removed. The procedure is as follows:



Caution! Danger of injury!

Switch off the main switch! Before starting the setting operation, wait until the motor stops!

- Loosen the screw (1) of the tensioning roller (2) and loosen it.
- Loosen the screws (3) of the pulley (4) and shift it to the left in such a way that the screws (5 and 6) of the feeding clutch (7) are accessible.
- Loosen the screws (5 and 6).
- Loosen the screws (8) of the axial rings (9).
- Push the shaft (12) to the right in such a way that it is out of the pulley (4).
- Remove the pulley (4).
- Remove the front guard.
- Loosen and unscrew the screw (14) of the holder of the wheel (15) and remove it from the holder (24).
- Loosen the screws (16 and 17) of the holder (18).
- Remove the holder (18) together with the holder (15) and articulated shaft (13) from the machine.
- Loosen the screws (19) of the pulley (20).
- Loosen the screw (24) of the ring (25).
- Hold the pulley (20) and pull out the feeding shaft (22) from the arm in such a way that it is possible to remove the indented belt (23) from the arm of the machine.
- Replace the belt with a new one and proceed to the assembly (inverted procedure of dismantling).
- Proceed to the setting operation according to the par. 3.7.3, 3.7.4 and 3.7.5.

3.7.7 Top roller

3.7.7.1 Selection of the top roller diameter

The machine can be supplied with two types of top roller, namely with the diameter of 25 mm and with the diameter of 35 mm. The suitability of the diameter used depends on the type of sewing and on the concrete technological operation. There are in general valid the following principles for the selection of the wheel diameter:

- ø 25 mm - for sewing small radii
- ø 35 mm - for sewing straight sections or big radii
- for sewing with great passages to thicker materials

3.7.9.2 Forward, rearward and side setting

The top roller must be in a defined position in relation to the needle:

- a) view (see Fig. 1) - the value „X“ depends on the diameter of use top roller (ø 25 - 6.5 mm; ø 35 - 10.5 mm), it is measured from the the needle bar up to the roller edge when turning the handwheel to the 180° of the scale against the indicator
- b) view (see Fig. 2) - the wheel edge must fit with the edge of the needle operture at the spot of the needle punch.

These values are to be set as follows:



Caution! Danger of injury!

Switch off the main switch! Before starting the setting operation, wait until the motor stops!

- Loosen the screw (1).
- By shifting the holder (2) with the top roller (3) in the groove of the holder (4) set the required value „X“ and tighten the screw(1).
- Loosen the screw (5).
- By shifting the holder (2) in the holder (6) set the bottom edge of the roller to the edge of the needle operture.
- Tighten the screw (5).

Fig. 1

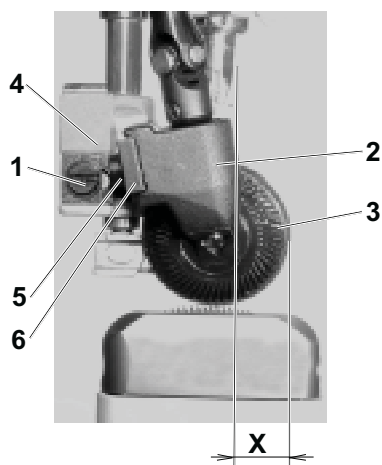
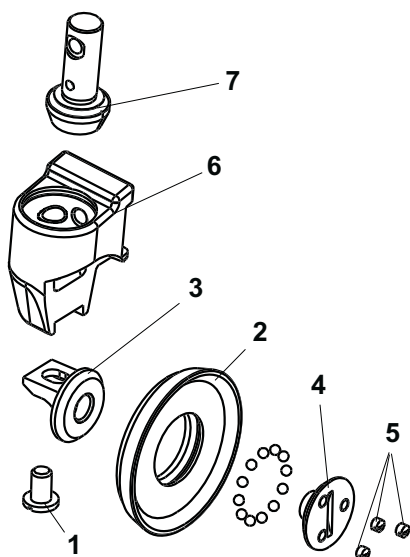
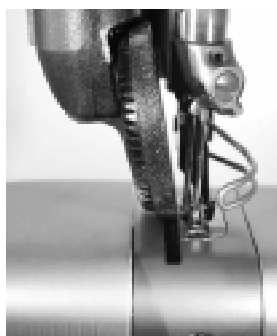

Fig. 2



3.7.7.3 Setting the gear clearance

and in the mounting of the top roller

In the cone gear of the drive of the top roller foot, the minimum clearance must be set. A too small clearance will increase the friction resistance of the gear, the excessive clearance will influence the inaccuracy of feeding. The top roller itself is mounted on balls. With this type of mounting, it is also necessary to set the minimal possible radial clearance.

The given clearances are set as follows:



Caution! Danger of injury!

Switch off the main switch! Before starting the setting operation, wait until the motor stops!

Clearance in the wheel mounting

- Loosen three screws (5) /only slightly/.
- Using the screw (4) set the minimum clearance in the top roller mounting (2) /it must easily rotate without any rubbing and with a minimum clearance/.
- Tighten the screws (5), check the set up clearance, eventually, repeat the setting procedure.

Clearance in the conic gear

- Loosen the screw (1), in shifting the wheel, resp. the holder (3) in the holder groove (6), set the minimum clearance, the pinion (7) must be pushed up to the holder bottom (6).
- Tighten the screw (1), check the set up clearance.

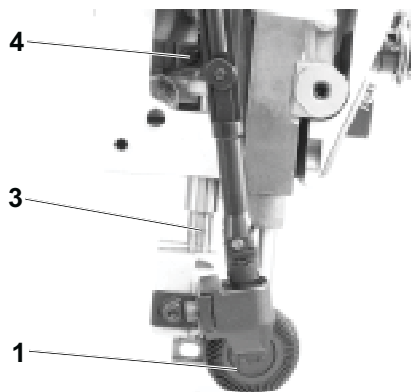
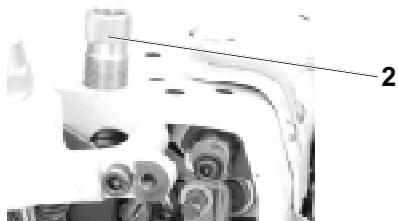

3.7.7.4 Setting of the height and of the pressing force of the top roller

Check the setting in the bottom dead centre of the bottom feeder (the feeder is below the throat plate). The top roller in this position of the feeder must fit onto the throat plate insert without any clearance.

Set the pressing force of the top roller (1) in such a way, so that no slipping of the stitched material occurs when being fed.



Caution! Danger of injury!

Switch off the main switch! Before starting the setting operation, wait until the motor stops!

Setting of the top roller height

- Lower by hand the presser bar (3) with the top roller (1) above the throat plate.
- By turning the handwheel, set the feeder into its lower position (below the throat plate).
- Loosen the screw (4) and set the wheel in such a way, so that it rests on the throat plate insert.
- Tighten the screw (4).

Setting of the top roller (1) force

- Screwing in the screw (2), the pressing force of the top roller is increased and inversely.

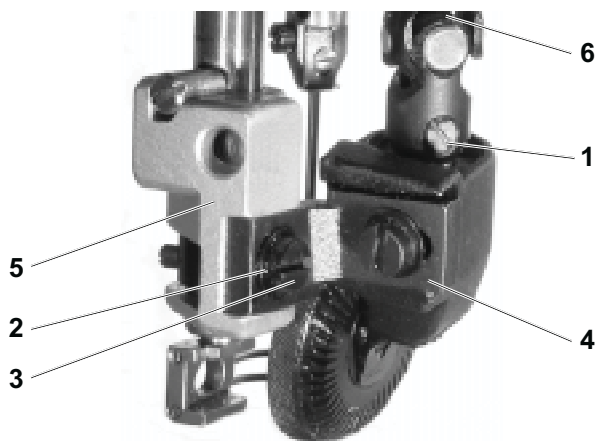

3.7.7.5 Replacement of the top roller

When replacing the top roller, proceed as follows:



Caution! Danger of injury!

Switch off the main switch! Before starting the setting operation, wait until the motor stops!

- Unscrew the screw (1).
- Unscrew the screw (3) with the washer (2).
- Remove the driven top roller with the holder (4) from the holder (5) and from the articulated shaft (6).
- Mount another top roller in inverted procedure to dismantling.
- Set the top roller according to the par. 3.7.7.2.

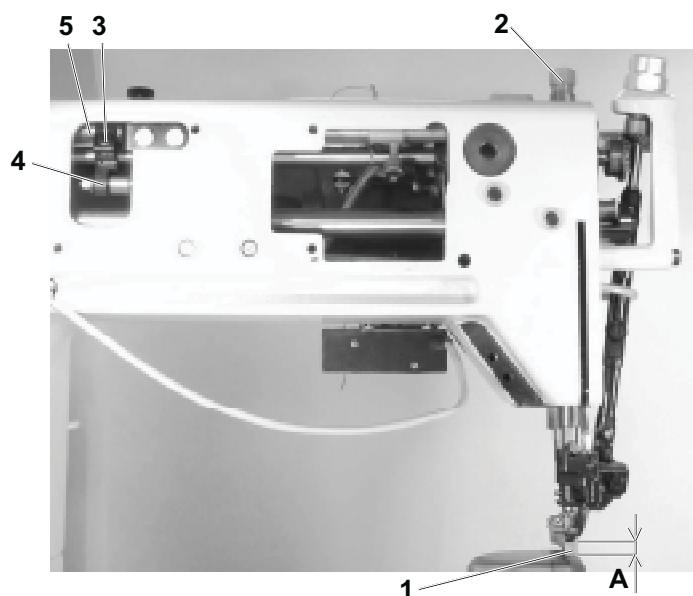

3.8 Setting the presser foot lift

The maximum lift of the presser foot when lifting the foot with knee lever or with electromagnet is to be „A“ = 12.5 mm.



Caution! Danger of injury!

Switch off the main switch! Before starting the setting operation, wait until the motor stops!

- Place a cube (1) having the height of „A“ = 12.5 ± 0.7 mm under the presser foot.
- Screw in thoroughly downwards the screw (2).
- Tighten slightly the screw (3) in such a way that the lever (4) turns on the shaft (5) with a certain friction moment.
- Push with the screwdriver on the lever (4), until it attains the wall inside the arm of the sewing machine.
- Return the lever (4) back by about 1 mm and tighten the screw (3). With the maximum top roller lifting, the lever will not strike into the machine arm.
- Check the axial clearance of the shaft (5) which should be the least possible.
- Using the screw (4) set the normal pressure force of the presser foot.

3.9 Bobbin winder

3.9.1 Description

The winder (bobbin winder) winds a reserve of the hook thread. It is driven by a spring-mounted friction gear, which stops after having filled the bobbin.

An ideal winding is attained with a sufficient pretension of the thread obtained on the thread guide (4) and with 1 mm under the diameter of the bobbin. The shaft is mounted in a swinging way and the friction gear is put into engagement by means of a pickup lever (1) and a cam. The winder is fixed on the machine arm by two screws (3). The thread is passed through according to the illustration, the thread is cut off after having stopped the winding operation using the cutting device (5).

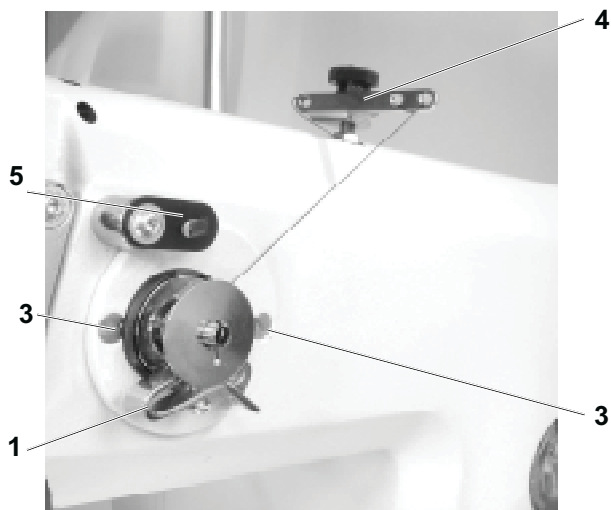

3.9.2 Setting the bobbin winder stop

The moment of interrupting the winding is determined by the mutual position of the pickup lever (1) and the cam (5) on a common shaft.

The cam is locked in its functional position by the screw (6). The mutual position is to be set on a not incorporated winder in such a way that in the moment, when the pickup lever leaves the space of the bobbin, the pressing function of the cam on the winder's shaft is interrupted and it moves in the sense of the arrow. A fine setting is to be done on an incorporated condition in the machine. Using the screw (2), the position of the friction part of the pickup lever (1) is adapted. In opening the lever, the stopping function is accelerated. Its inverse function delays it. A test is to be done after having inserted the bobbin, when passing the thread through the device and when winding at the running of the machine.

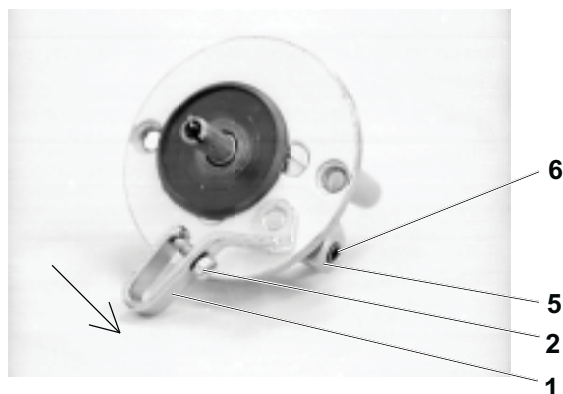

3.9.3 Setting the friction gear

The friction gear is formed frontally by the disk (8) on the main top shaft of the machine and by the disk (7) with a rubber ring on the shaft of the winder.



Caution! Danger of injury!

Switch off the main switch! Before starting the setting operation, wait until the motor stops!

- Proceed to the setting operation with a removed rear guard.
- The winder is in its stopped position.
- Loosen two screws (9) in the disk (8) through the hole in the arm.
- By shifting axially the disk in the sense A, B, set the disks of the winder (7) at the distance of 0.5 mm from the rubber ring.
- Tighten the screws (9) in the disk (8).
- Put the winder in its working position and proceed to a winding test.
- Mount the rear guard.

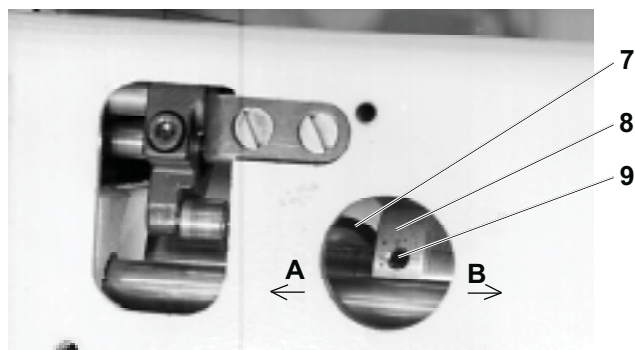

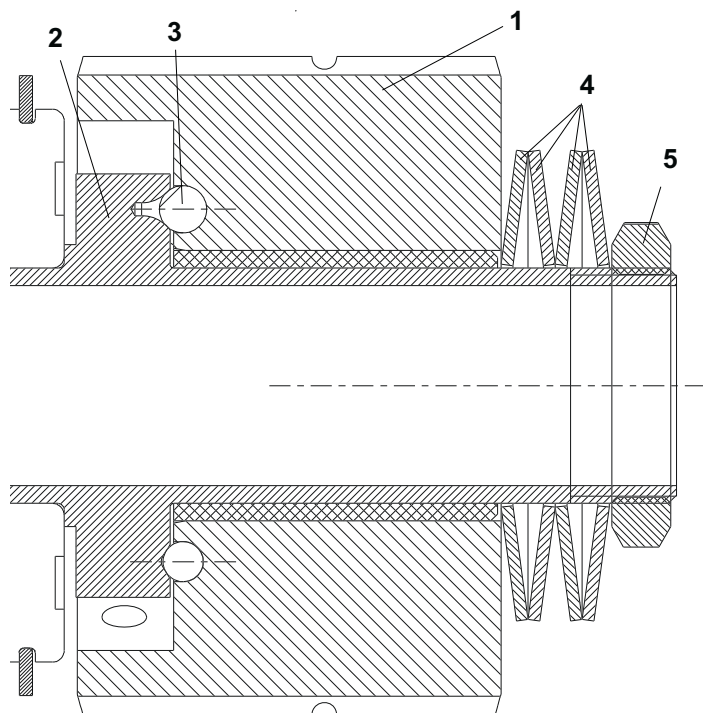

3.10 Safety clutch

3.10.1 Description

The machine is provided with a safety clutch which enables the turning through of the lower belt wheel (1) on the hub of the lower shaft (2), when the hook is blocked. This blocking occurs due to the penetration of thread into the hook path. With current running, this clutch should not disengage during the normal running. The mutual coupling of the belt wheel (1) and the hub (2) is effected by means of the bills (3) which are firmly connected with the belt wheel (1). The bills fit in the conic holes of the hub (2) and are pushed therein by means of the springs (4).

Putting the clutch in its working position, eventual checking its correct position are to be done in blocking the hook using a screwdriver and in turning a bit the handwheel.

3.10.2 Setting the disengaging moment



Caution! Danger of injury!

Switch off the main switch! Before starting the setting operation, wait until the motor stops!

The correct value of the tensioning moment (8 Nm) has been set up by the manufacturer. when this value is lower, in a current running, the clutch may disengage. In an opposite case (the moment is higher), the clutch will not disengage. In both cases it is necessary to proceed to a correction of the moment. In turning the nut (5) to the right, the moment will increase and on the contrary. The value of the tensioning moment is very sensible to the turning of the nut (5). When setting it, it is necessary to proceed very carefully, set it up only in emergency cases! Check the moment using a torque-limiting wrench.



Caution!

The clutch guarantees only one mutual position of the hub of the lower shaft (2) and that of the belt wheel (1). No checking according to the gauge marks is needed. Putting the clutch out of operation by excessive tightening of the nut (5) can cause, when blocking the hook, the destruction of the gear within the drive of the hook.

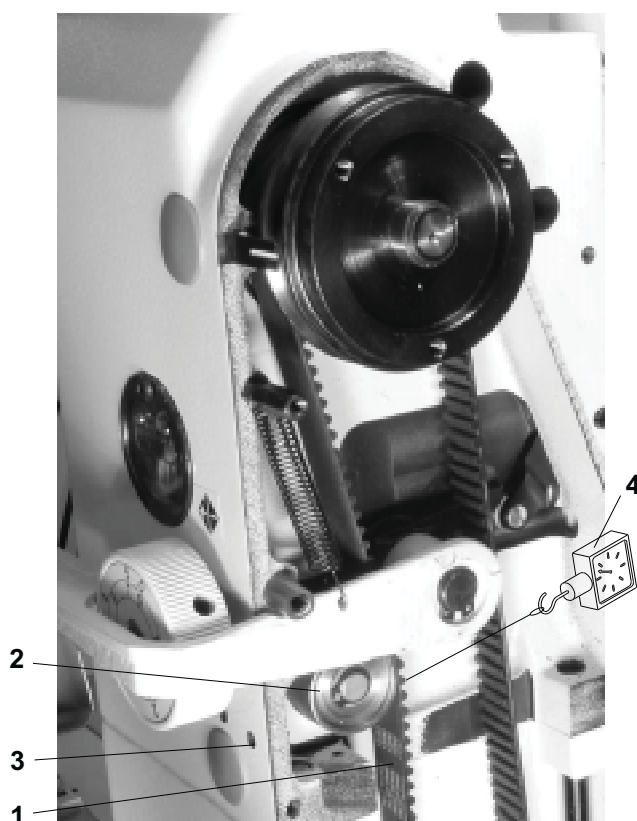

3.11 Indented belt transmission

3.11.1 Setting the tensioning roller of the indented belt

The optimum tension of the indented belt (1) is attained in setting the tensioning roller (2) in such position, when the roller applies the pressure of $F = 20 \text{ N}$ against the belt. The roller must be side set in such a way that the edge of the indented belt does not overlap over the edge of the roller.



Caution! Danger of injury!

Switch off the main switch! Before starting the setting operation, wait until the motor stops!

- Remove the handwheel and the belt guard, remove the V-belt.
- Unlock the fastening of the loop, on which the roller (2) is mounted in such a way that the loop turns freely.
- Lift the roller (2) upwards and, thereafter, using the dynamometer (4), pull horizontally the roller in applying the force of 20 N. In this position, tighten the fastening screw (3).
- Check the side shifting of the roller.

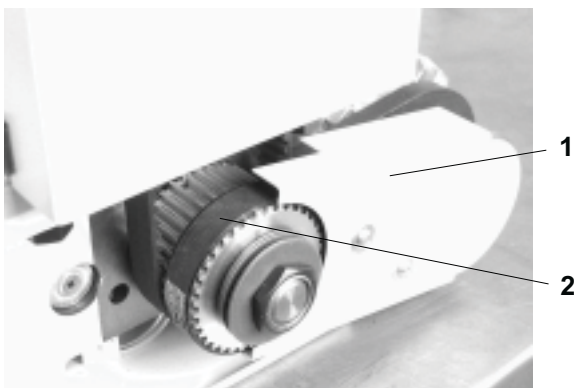
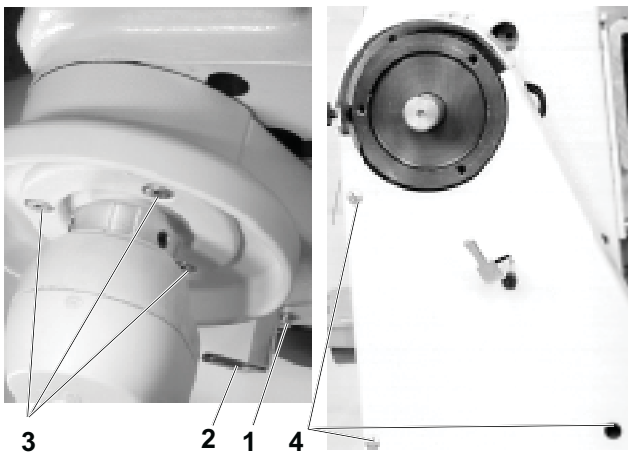
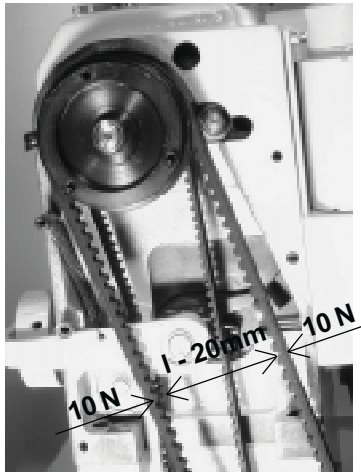
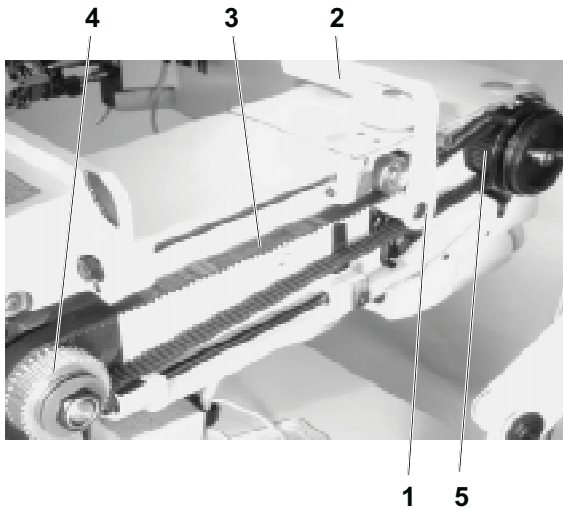

3.11.2 Replacing the indented belt

To observe: in machines with Mini-stop first remove the driving toothed belt as instructed in par. 3.13.

When replacing the indented belt, the mutual position of the pulleys (4 and 5) should be maintained.



Caution! Danger of injury!

Switch off the main switch! Before starting the setting operation, wait until the motor stops!

- Remove the handwheel, the belt guard and the V-belt.
- Remove the retaining ring (1) and remove the backtacking lever (2).
- Mark with a pencil the instantaneous position of the indented pulleys against the machine head in any position.
- Remove the indented belt (3) from the bottom indented pulley (4) first, and then remove the whole belt.
- Apply a new indented belt on the top indented pulley (5) first.
- Turn both indented pulleys in the formerly marked positions and apply the indented belt on the indented pulley (4).
- Tension the belt and mount the dismantled components in the inverse order.

3.12 V-belt, motor - head

3.12.1 Tensioning



Caution! Danger of injury!

Switch off the main switch! Before starting the setting operation, wait until the motor stops!

The belt is correctly tensioned, when the opposite sides of the belt approach one to another by up to 20 mm in applying the force of 10 N. The belt is tensioned in turning respectively the motor in its holder.

3.12.2 Replacing the V-Belt



Caution! Danger of injury!

Switch off the main switch! before starting the setting operation, wait until the motor stops!

- Loosen the screw (1) of the positioner arrest (2) and tilt the arrest.
- Unscrew the screws (3) of the handwheel.
- Unscrew the screws (4) of the belt guard and tilt the guard.
- Remove the belt guard of the motor and tilt the protections against falling out the belt from the motor pulley.
- Replace the belt.
- Tension the belt (see par. 3.12.1).

3.13 Driving toothed belt

3.13.1 To exchange the driving toothed belt



Caution! Danger of injury!

Switch off the main switch! before starting the setting operation, wait until the motor stops!

- Remove the machine head from the stand (uncouple the motor cables, the machine head cable and screw off the wood screw and the screw from the hinges).
- Remove the belt guard (1).
- Replace the belt (2).

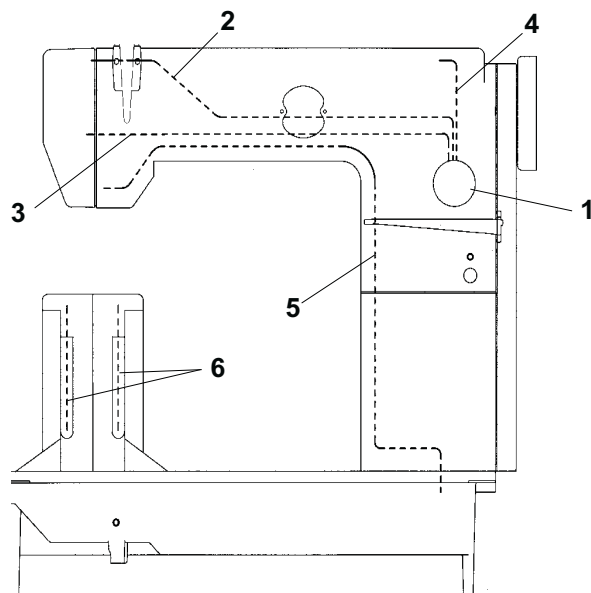

3.14 Lubrication

3.14.1 Description

From the lubricating tank (1) there issue three suction wicks. The wick (2) lubricates the pin of the thread mechanism, the wick (3) lubricates the needle mechanism and the wick (4) lubricates the stitch length mechanism. The superfluous oil from the needle and thread mechanisms is sucked off by the wick (5) and lubricates the shifting wedge of the feeding clutch.

The hooks are provided with their own oil reservoirs (6). The superfluous oil from the hooks lubrication lubricates the driving gear of the hooks.

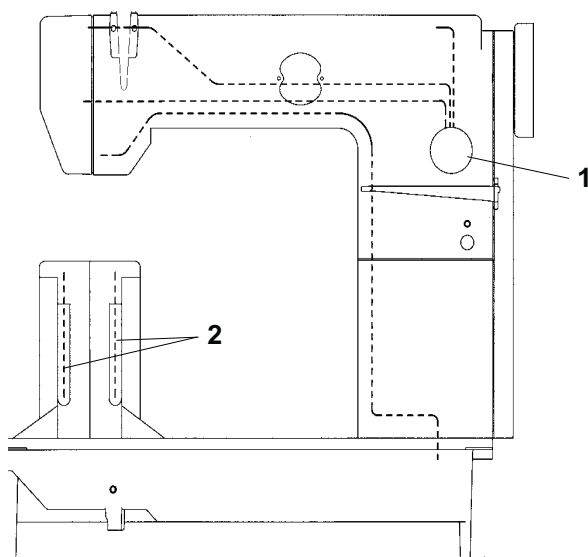

3.14.2 Refilling oil

For lubricating the machine oil Esso SP-NK 10, DA 10 is used or other oil with the same quality. When putting the machine into operation, each mechanism of the machine is to be lubricated with several drops of oil. Oil is only refilled thereafter into the oil reservoirs using an oil can into the holes in the oil level indicators. The oil tank (1) of the central distribution is to be filled up to the mark max.

The oil tanks (2) of the hooks lubrication are to be filled up to the upper edge.

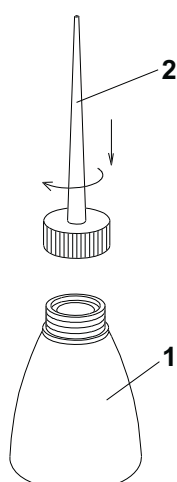
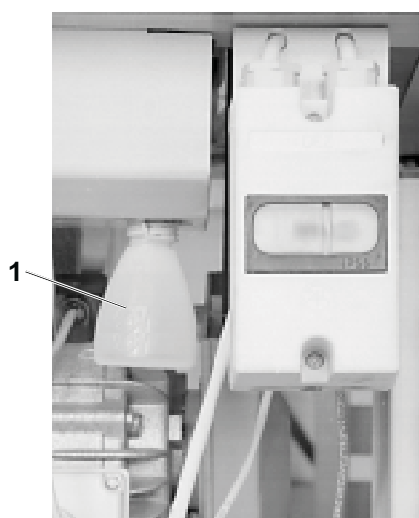

3.14.3 Multiple oil use

Oil which runs into the oil cup is collected in the collector (1) and may be reused for refilling the oil reservoirs in the machine - see par. 3.14.2.

The oil collector (1) with the collected oil is unscrewed and the top part of the oil can (2) which is added in the machine packing is screwed in. Oil is then refilled into the reservoirs on the machine head and everything is put into the original condition.

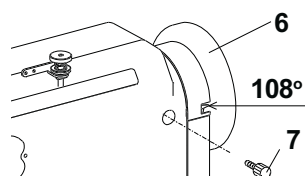
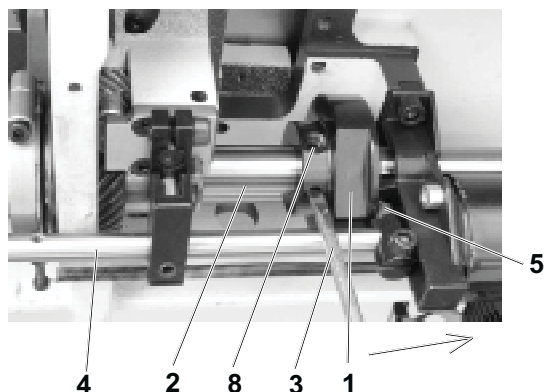
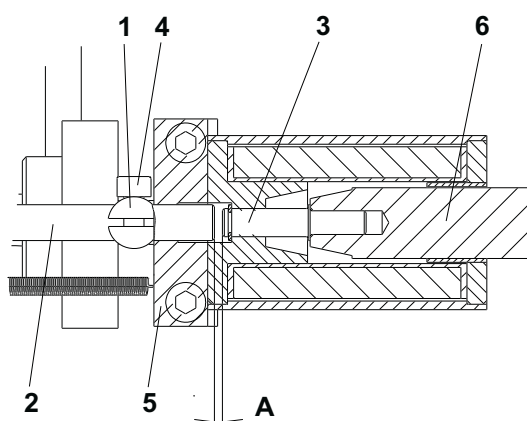
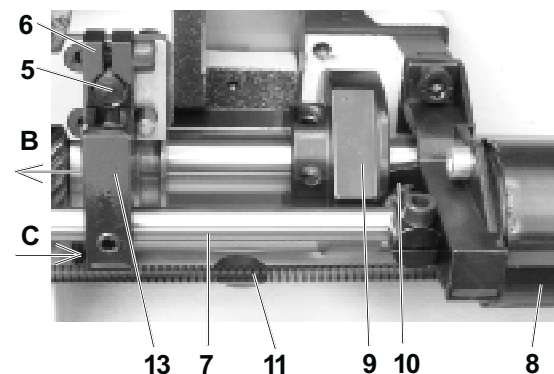
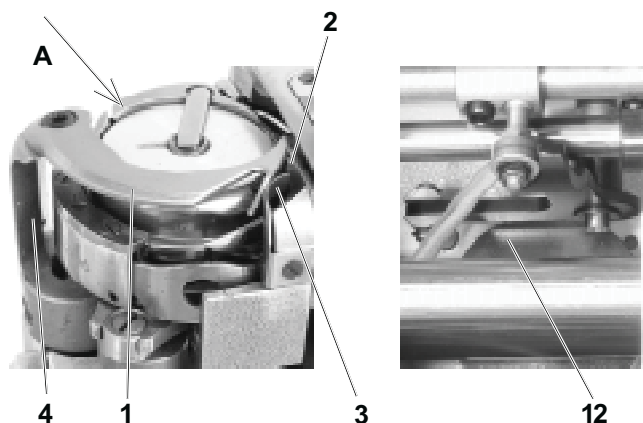

4. Thread trimming

4.1 Description of the trimming mechanism

During the trimming cycle, the moving trimming knife (1), in an opportune moment, hooks up the sewing threads and pulls them in the sense of the arrow (A) against the fixed knife (2) until the threads are trimmed. The spring (3) holds the hook thread after being trimmed off. The moving trimming knife (1) is fastened on the holder (4) and the holder is fastened on the shaft (5). This shaft is turned by means of the lever (6) under the effect of the fork (13) fastened on the shaft (7), which is shifted by the electromagnet (8) from its starting position in the sense of the arrow (B). When moving back in the sense of the arrow (C), the shaft (7) is shifted by the cam (9) through the pickup roller (10) into the starting position. The spring (11) maintains the mechanism in its starting position. The electromagnet (12), in an opportune moment, loosens the main tensioner. At the end of the trimming cycle, both electromagnets (8 and 12) are switched off.

4.2 Setting the pickup roller

The holder of the pickup roller (1) is to be fixed in such a way that it is positioned, in its starting position, between the shaft (2) and the shaft (3), the respective gap „A“ = 0.2 to 0.4 mm.



Caution! Danger of injury!

Switch off the main switch! Before starting the setting operation, wait until the motor stops!

- With the loosened screw (4), put the holder of the pickup roller (1) up to the stop against the bracket (5) and, at the same time, the shaft (2) up to the stop against the shaft (3).
- With the holder (1) held on the stop, shift the shaft (2) in such a way that there appears the gap „A“ = 0.2 to 0.4 mm, and tighten the screw (4).
- Check the gap „A“ in shifting the armature (6).

4.3 Setting the cam

The position of the cam (1) against the shaft (2) is to be such, so that when the adjusting pin is in contact with the shaft (4), the protractor scale of the handwheel (6) shows just the angle of 108°. If the pickup roller (5) is in its starting position of rest, the clearance between the roller (5) and the cam (1) should be as small as possible but sufficient to prevent the cam from getting into accidental contact with the roller.



Caution! Danger of injury!

Switch off the main switch! Before starting the setting operation, wait until the motor stops!

- Set the angle of 108° on the handwheel (6) and lock it with the screw (7) which is included in the accessory of the machine (tighten with care).
- Shift the pickup roller (5) in the sense of the arrow up to the stop.
- Insert the adjusting pin (3), which is included in the accessory, into the cam and turn the cam, until the pin (3) gets the contact with the shaft (4).
- Insert a gauge having the thickness of 0.1 mm between the cam (1) and the pickup roller (2) and shift the cam against the gauge up to the stop. Tighten then the screw (8).
- Loosen the blocking of the handwheel, turn a bit the cam and tighten the second fastening screw of the cam too.

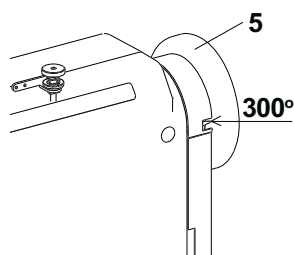
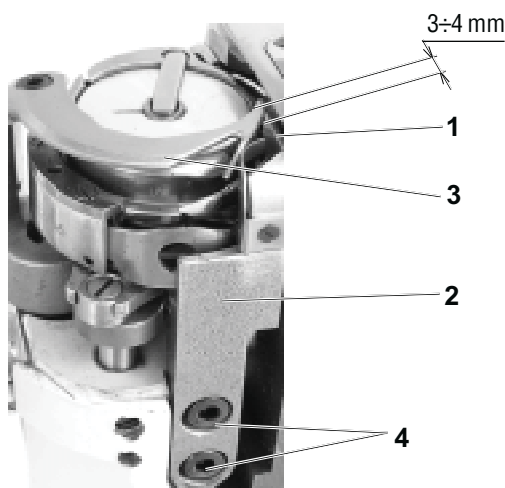
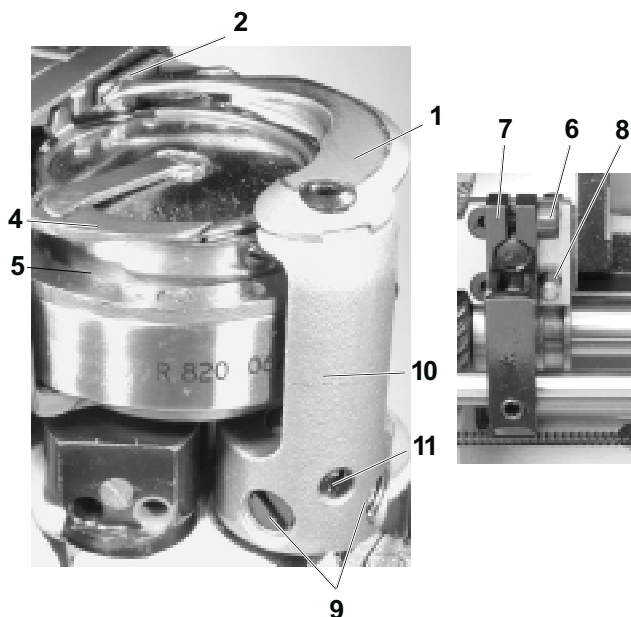
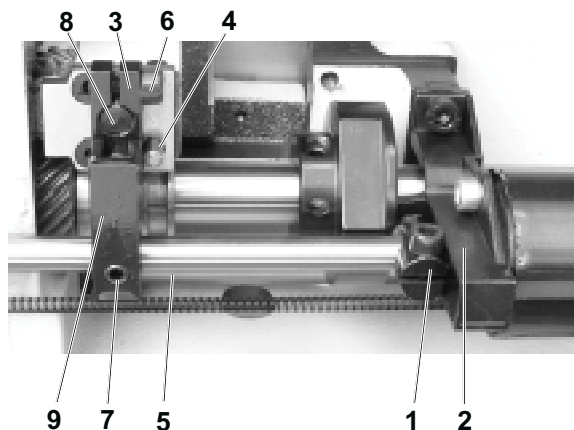

4.4 Setting the fork

In the starting rest position of the trimming mechanism, when the holder (1) is in contact with the console (2), the lever (3) must be in contact with the stop (4).



Caution! Danger of injury!

Switch off the main switch! Before starting the setting operation, wait until the motor stops!

- Shift the shaft (5), until the holder (1) strikes the bracket (2).
- Loosen the screw (6) and (7).
- Shift the lever (3) to the stop (4) /mind the axial clearance of the eccentric shaft (8)/ and tighten the screw (6).
- Slip on the fork (9) on the pin of the lever (3) and retighten the screw (7).

4.5 Setting the moving knife

The movable trimming knife (1) is to be, in its starting rest position, in alignment of its end with the edge of the fixed trimming knife (2). It is to be set in height in such a way, so that its bottom surface (3) passes above the surface (4) of the middle part (5) of the hook with the clearance of about 0,3 mm.



Caution! Danger of injury!

Switch off the main switch! Before starting the setting operation, wait until the motor stops!

- Loosen the screws (6) of the lever (7).
- Turn the movable trimming knife (1) in alignment with the fixed knife.
- Tighten the screw (6) /the lever (7) must be leaning against the stop (8) and the axial clearance of the trimmer shaft must be maintained/.
- Loosen the screws (9) of the knife holder (10).
- In turning the screw (11), set the height of the movable trimming knife (1). Tighten the screws (9).

4.6 Setting the fixed knife

The fixed trimming knife (1) is to be spring loaded through swinging out of the knife holder (2) in such a way, so that it fits on the movable trimming knife at the distance of about 3 - 4 mm from the end of the movable knife. In its height position, the fixed knife is to be set with its upper surface above the movable trimming knife (3) by about 0,1 mm. The knives need not to trim untensioned threads.



Caution! Danger of injury!

Switch off the main switch. Before starting the setting operation, wait until the motor stops!

- With loosened screws (4), proceed to the height setting of the knife.
- Tighten slightly the bottom screw (4).
- Set the angle of about 300° on the handwheel (5).
- Shift by hand the moving knife (3) into the marked position.
- In swinging out the knife holder (2) set by way of trial the spring loading of the fixed trimming knife (1).
- Tighten both screws (4).
- Check the bearing spot of the moving trimming knife (3) on the fixed trimming knife (1) and give it a correction, if needed.

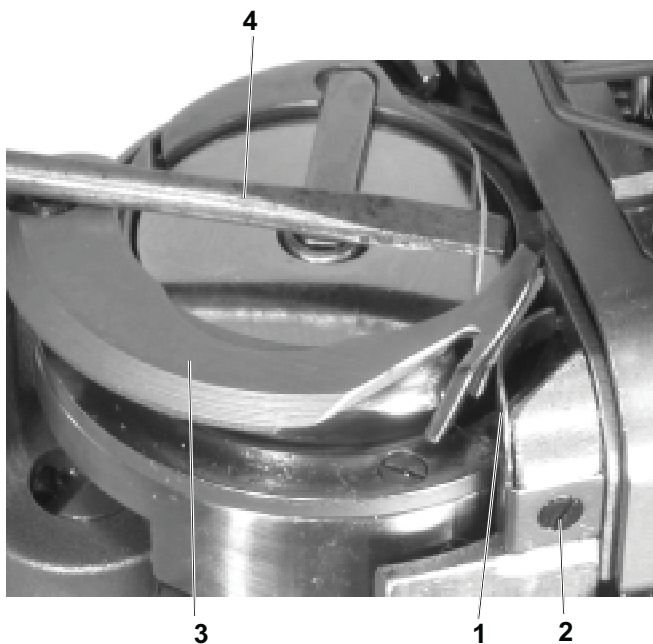

4.7 Setting the retaining spring of the hook thread

The retaining spring (1) holds the hook thread after having performed the trimming. It is to be set in such a way that the force necessary for pulling out the thread from the retaining spring (1) is approximately equal to the force necessary for pulling out the thread from the hook.



Caution! Danger of injury!

Switch off the main switch! Before starting the setting operation, wait until the motor stops!

- In an emergency case, shape the retaining spring (1) in such a way that it fits close with all its surface (without wedge) onto the moving trimming knife (3) and so that, with the slightly tightened screw (2), onto the moving trimming knife without any pressure.
- Tighten the screw (2), until the necessary force for pulling the thread from the retaining spring is attained. The pulling force is tested using a screwdriver (4) according to the illustration.



Caution!

The setting of the retaining spring (1) depends on the setting of the hook thread tension and differs then according to the respective sewing category.

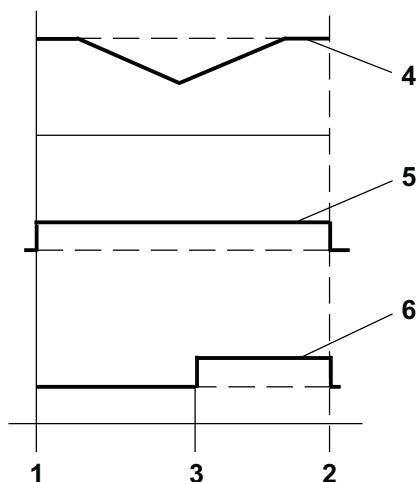

4.8 Setting the switching of electromagnets

The electromagnets of the trimming device and loosening of the tensioner must work in accordance with the diagram. This is ensured by setting the stopmotor (see the instructions for use of the stopmotor).

- 1- 1. position of the needle (135° on the handwheel);
- 2- 2. position of the needle (64° on the handwheel)
- 3- position of stopping the tensioner (10° ÷ 25° on the handwheel)
- 4- movement of the pickup roller of the trimmer cam
- 5- current of the trimming device electromagnet
- 6- current of the tensioner loosening electromagnet

5. Lifting the top roller by electromagnet

5.1 Description

The core of the electromagnet, respectively its pin must be set in such a way that the presser foot lifting is enabled.

5.2 Setting the electromagnet pin



Caution! Danger of injury!

Switch off the main switch! Before starting the setting operation, wait until the motor stops!

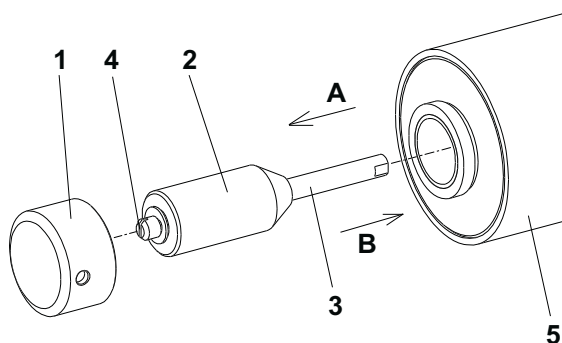

- Unscrew the cap of the core (1) of the electromagnet.
- Shift the core (2) with the pin (3) and unscrew the locking screw (4).
- Unscrew the pin (3) in the core (2) in the "A" direction up to the stop.
- Push the core (2) into the magnet (5) in the "B" direction up to the stop.
- In this position, set the maximum top roller lifting in the "B" direction.
- Screw on and tighten the arresting screw (4).
- Screw on the cap (1).

5.3 Setting the electromagnet current

The time response of the current of electromag. has 2 phases:

- initial switching on (0,2 ÷ 0,5 s) - the maximum force
- maintaining (when keying)



It is necessary to set max. 40 % of keying (see instructions for use of the stopmotor). With a higher value thereof and with a long period of the presser foot in its lifted position there is a danger of electromagnet overheating.

5.4 Assembly of the top roller lifting electromagnet



Caution! Danger of injury!

Switch off the main switch! Before starting the setting operation, wait until the motor stops!

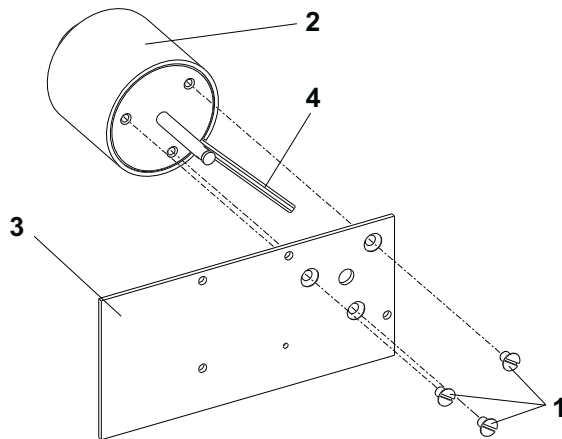

- Remove the rear guard (3).
- Using the screws (1), fasten the electromagnet (2) on the rear guard (3) with the given orientation of the outlet cable (4).
- Mount the rear guard (3).
- Connect the outlet cable (see par.7).
- Set the pin of the electromagnet (see par. 5.2).
- Set the current of the electromagnet (see par.5.3).

6. Backtacking using electromagnet

6.1 Description

The position of the electromagnet with regard to the backtacking lever must be set in such a way that it enables the maximum stitch length when sewing in forward and in rearward sense. If this position is not correct, the length of the stitch will be shortened in one or the other feed direction.

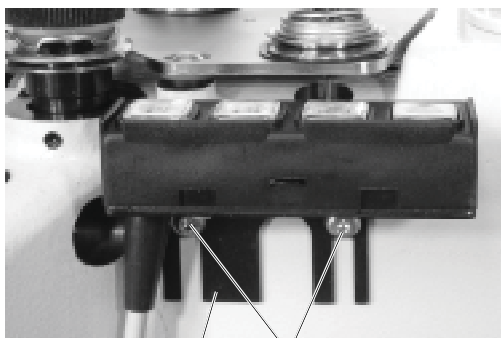
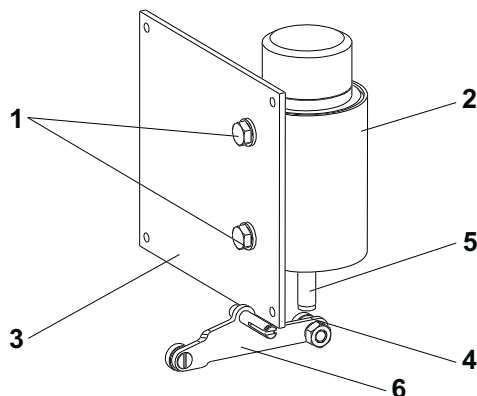

6.2 Electromagnet height setting



Caution! Danger of injury!

Switch off the main switch! Before starting the setting operation, wait until the motor stops!

- Set the position of the electromagnet (2) in the upper position of the grooves of the guard (3).
- Proceed to the mounting of the guard (3) with the magnet on the machine head.
- Set the maximum stitch length and push the reverse stitching lever into its bottom position (as with the reverse stitching operation).
- In this position, the bar (5) must be in contact with the roller (4) of the lever (6). Otherwise shift the electric magnet (2) in the grooves of the guard (3).

6.3 Setting the position of push-buttons



Caution! Danger of injury!

Switch off the main switch! Before starting the setting operation, wait until the motor stops!

- By loosening the screws (1), it is possible to set the position of the holder of the push-buttons (2) in the sense of sewing.

6.4 Change of the function of push-buttons

The Function of the push-buttons can be changed in accordance with the possibilities given by the stopmotor (see instruction for use of stopmotor).

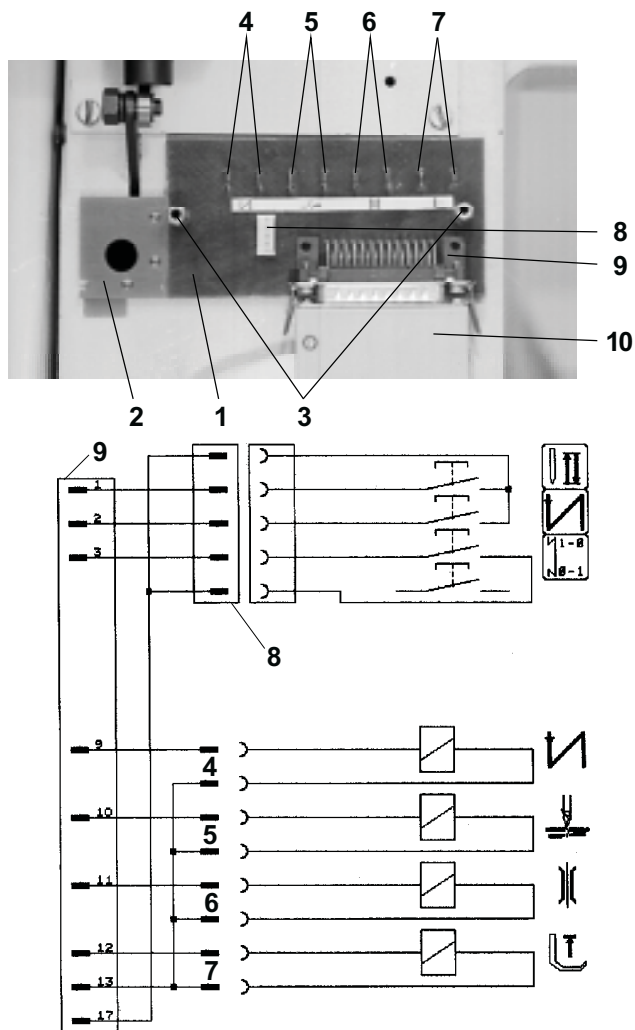

7. Connecting the electric elements on the machine head

The connection of the electric elements (electromagnets, backtacking, presser foot lifting, thread trimming, loosening of the tensioner and push-buttons) is made by means of a switchboard (1) fixed with its supporting plate (2) on the rear side of the head by means of two distance screws (3) (In the Fig., these electric elements are disconnected).

Connecting spots :

- 4 - backtacking electromagnet
- 5 - trimming electromagnet
- 6 - tensioner loosening electromagnet
- 7 - presser foot lifting electromagnet
- 8 - connector of push-button connecting
- 9 - connector of coupling the head with the stopmotor
- 10 - connecting cable of the head and stopmotor

Wiring diagram of connecting the electric elements of the machine head.

8. Drive, control panel, position sensor

The detailed information concerning the drive, the control panel and the setting of the position sensor is given in the manual of the drive and of the control panel.

9. Maintenance



Caution! Danger of injury!

The maintenance operations should be performed only with the machine switched off and with the motor stopped!

In the following table there are given the operations which should be performed and the respective time intervals between the individual operations.

Operation	Time interval
Removal of the throat plate and its cleaning out. Cleaning out of the feeder, hook and their surrounding space. Removal of the residues of material and threads from the top roller.	1 day
Checking of the oil level in the oil tanks of the hooks.	1 week
Checking of the oil level in the central oil tank.	1 month
Checking the hooks wear. Checking the function of the safety clutch against the hook overload.	6 months
Checking the V-belt and the indented belts.	1 year

10. Setting the machine according to the sewing category

10.1 Introduction

This sewing machine enables sewing operations within a large extent from 1. 2 to 3.2 mm the light up to the heavy-duty sewing. The parameters of the respective sewing operation must be in accordance with the given machine setting which includes also the replacement of some components, such as the needle, the throat plate insert. For this reason, the setting of the machine is divided into 4 categories:

- 1 ... light sewing
- 2 ... medium sewing
- 3 ... medium heavy-duty sewing
- 4 ... heavy-duty sewing

In the factory, where this machine has been manufactured, the machine has been set with respect to the standard parameters of the required sewing category which is designed by the number included in the commercial designation of the machine. If the user desires changing the given setting to another sewing category, this operation should be performed by a specialized mechanician.

The standard parameters of sewing are described in the following paragraph. The actual parameters of sewing inside the given sewing category may be different, which means that the machine operative must adapt respectively the setting of the machine, e.g. the tension of the upper thread.

10.2 Table of setting the machine according to the sewing category

Commercial designation of the machine 4220i - 6XX - X

Sewing category	Standard sewing parameters					Standard machine setting ¹⁾									
	Seam distance	Thickness of one material layer	Number of material layers	Stitch length	Label number of thread PES	Needle size	Sewing speed	Diameter of needle plate insert	Feeder - pitch of teeth hole	Presser top roller diameter	Presser top roller position	Thread tension ³⁾		Splice of hook	
												needle thread	hook thread		
	mm	mm		mm		0,01mm	SPM	mm	mm	mm	mm	N	N		
-100	1,2	0,8	2	2	70	80	2500	1,3	1,0	35	10,5	3	1	● 7)	●
-200	1,6	1	2	3	40	90	2000	1,6	1,0	35	10,5	4,5	1,5	● 7)	●
-300	2	1,5	1-2	5	20	130	1200	2,2	1,5	35	10,5	5 - 8	2		●
-400	2,4	2	1-2	5	10/20 4)	180	800	2,5	1,5	35	10,5	10-12	2 - 2,5		●
Setting as per chapter		Instructions for service				3.3.2	3.6.2.8	3.7.7.1	3.7.7.2						
		Instructions manual		6.5								6.4	6.4		
		Instructions for assembling			2,4 4.5										

- 1) The standard setting of the machine for the categories 3 and 4 concerns a decorative stitching, when it is difficult to match a good stitch interlocking with a faultless function of the thread trimming device. Otherwise, when sewing material of considerable overall thickness, it will be necessary to increase the overtopping of the teeth above the needle plate and to increase also the needle thread tension.
- 2) The thickness of a layer is measured using an engineer slide calliper with the pressure of jaws of about 10 N.
- 3) The values of tension are only orientative ones and it is necessary to adapt especially the tension of the shuttle thread according to the stiffness of the material. An excessive tension of the threads when sewing soft materials causes material wrinkling.
- 4) When performing decorative stitching of the category 4, the hook thread having the label No 20 is used.
- 5) When changing markedly the sewing category together with changing the tension of the shuttle thread, it is necessary to modify the tension of the retaining spring of the trimming device according to the paragraph 4.7.
- 6) There are in use various types of feeders with the purpose of avoiding imprinting the teeth in the lining leather. Otherwise, it is possible to use any feeder.
- 7) The splice with the so-called spur may be used with the sewing categories 100 and 200 and is designed for sewing thin materials. In the production factory, the gib without spur is mounted as standard.
When using the gib with the so-called spur, we recommend carrying out the setting of the pin of the thread mechanism (par. 3.2.4) for the sewing category 400.

10.3 Table of possible stitch widths of needles according to the sewing category

Sewing category	Distance of seams (stitch width)					Maximum stitch length
	1,2	1,6	2	2,4	3,2	
	mm					mm
- 100 Light	●					3
		●				3
- 200 Medium		●				5
			●			5
				●		5
- 300 Medium heavy -duty		●				7
			●			7
				●		7
- 400 Heavy - duty (decorative)			●			7
				●		7
					●	7